

SoftBank 007Z

User Guide



SoftBank

Introduction

Thank you for purchasing SoftBank 007Z High Speed Mobile Wi-Fi Router.

- SoftBank 007Z is referred to as "Wi-Fi router" in this guide.
- Read this guide thoroughly beforehand for proper usage.
- Accessible services may be limited by contract conditions or service area.
- This Wi-Fi router is compatible with 3G network technologies.

Notes

- Unauthorized copying of any part of this guide is prohibited.
- Contents are subject to change without prior notice.
- Steps have been taken to ensure the accuracy of descriptions in this guide. If you find inaccurate or missing information, contact SoftBank Customer Support, General Information (P.7-3).

Chapter Contents At a Glance

Getting Started	1
Using Wi-Fi (WLAN)	2
Using Micro USB Cable (PC)	3
Using Micro USB Cable (Mac)	4
Settings	5
Troubleshooting	6
Appendix	7

Contents

Contents.....	iii
Introduction.....	iv
Safety Precautions.....	v
General Notes.....	xi
Trademarks	xiii

1 Getting Started

Getting Started.....	1-2
Package Contents.....	1-2
Parts & Functions.....	1-3
USIM Card.....	1-5
Memory Card.....	1-7
Battery	1-8

2 Using Wi-Fi (WLAN)

Using Wi-Fi (WLAN).....	2-2
WLAN.....	2-2
Connecting Wi-Fi Devices via WLAN	2-2
Connecting Windows.....	2-8
Connecting Mac	2-11

3 Using Micro USB Cable (PC)

Using Micro USB Cable (PC)	3-2
Device Recognition (PC).....	3-2
Software Installation (PC).....	3-2
Connecting to Internet.....	3-7
Device Removal (PC)	3-8

4 Using Micro USB Cable (Mac)

Using Micro USB Cable (Mac)	4-2
Device Recognition (Mac)	4-2
Software Installation (Mac)	4-2
Connecting to Internet.....	4-4
Device Removal (Mac).....	4-5

5 Settings

Settings	5-2
Overview.....	5-2
WLAN & WAN Information	5-3
Advanced Settings	5-4
Changing Security	5-20
Internet Connectivity	5-21

6 Troubleshooting

Troubleshooting	6-2
-----------------------	-----

7 Appendix

Appendix	7-2
Specifications.....	7-2
Warranty & Service	7-2
Customer Service	7-3

Factory Default Settings

Use this information to connect Wi-Fi router to Wi-Fi devices.

SSID and security keys are set by default. See WLAN Initialization Sticker ("Package Contents" P.1-2) for SSID, WEP Key, and WPA Key.

- Internet connectivity (WAN Connection Mode in SoftBank 007Z Utility) is Always On by default. Use SoftBank 007Z Utility to change to Manual. See "Internet Connectivity" P.5-21.
- Encrypt Type is set to WEP by default. For greater security, use WPA/WPA2. Some game consoles may not be WPA compatible. See game console user guide for compatibility.

Operating Environment

Use Wi-Fi router in any of these operating environments:

- Compatible Operating Systems:
 - Windows XP Home Edition (Service Pack 2 or later)
 - Windows XP Professional (Service Pack 2 or later)
 - Windows XP (64-bit)
 - Windows Vista Home Basic (32-bit or 64-bit)
 - Windows Vista Home Premium (32-bit or 64-bit)
 - Windows Vista Business (32-bit or 64-bit)
 - Windows Vista Ultimate (32-bit or 64-bit)
 - Windows 7 Starter Edition (32-bit or 64-bit)
 - Windows 7 Home Basic (32-bit or 64-bit)
 - Windows 7 Home Premium (32-bit or 64-bit)
 - Windows 7 Professional (32-bit or 64-bit)
 - Windows 7 Enterprise (32-bit and 64-bit)
 - Windows 7 Ultimate (32-bit or 64-bit)
 - Mac OS X 10.4 to 10.6 (Intel)
- Compatible OS includes both English and Japanese versions.
- Memory Requirements:
 - Windows XP: 256MB (512MB+ recommended)

Windows Vista: 512MB (1GB+ recommended)

Windows 7 (32-bit): 1GB+

Windows 7 (64-bit): 2GB+

Mac OS X: 256MB (512MB+ recommended)

- Available Hard Disk Capacity:
 - 50MB required (100MB+ recommended)
- Recommended resolution: Over 1024 × 768
- Compatible browser: Windows Microsoft Internet Explorer 6, 7, 8
Mac OS X: Safari 3, 4

Use outside these environments may affect performance. Operating environment (hardware, connected peripherals, installed applications, etc.) may also affect performance.

- For PC support, OS version upgrade information, etc., see corresponding manufacturer's product support documentation.

Usage Conditions



- Wi-Fi router is for use within SoftBank Mobile service areas/areas covered by SoftBank Mobile Global Roaming Service.
- Even within service areas, transmissions may be disrupted inside buildings, aboard trains, inside tunnels, underground, behind buildings, in valleys, etc. Signal may be weak in some areas. Signals may not travel well in some areas in certain regions.
- Extremely strong or weak signals may disrupt transmissions. Transmissions may be disrupted even when signals are fine.
- Router transmissions are highly secure, however, eavesdropping can occur. Please use accordingly.
- Wi-Fi router is a radio as stipulated by the Radio Law. Under this law, it must be submitted for inspection upon request.
- In public places please use Wi-Fi router without disturbing others.
- USIM Card must be installed to use Wi-Fi router.
- SoftBank Mobile is not liable for any damages/recovery costs associated with Wi-Fi router use.

Safety Precautions

- Read Safety Precautions before using Wi-Fi router.
- Observe precautions to avoid injury or property damage.
- SoftBank is not liable for damages incurred by the user or third parties due to Wi-Fi router malfunctions, incorrect operations, or inconveniences caused by missed transmissions.

Labels

These labels indicate the degree of risk from improper use. Make sure you thoroughly understand meanings before reading on.

 DANGER	Great risk of death or serious injury ¹
 WARNING	Risk of death or serious injury ¹
 CAUTION	Risk of injury ² or damage to property ³







¹Includes blindness, wounds, low/high heat burns, electric shock, bone fractures, poisoning or other physical harm with aftereffects, or requiring hospitalization or ongoing hospital visits.

²Includes wounds, burns, electric shock or other physical harm not requiring hospitalization or ongoing hospital visits.

³Includes damage to home, furniture, livestock, pets, etc.

Symbols

These symbols indicate prohibited or compulsory actions. Make sure you thoroughly understand meanings before reading on.

 Prohibited	Prohibited actions
 Do Not Disassemble	Disassembly prohibited
 Avoid Liquids Or Moisture	Exposure to liquids prohibited
 No wet hands	Handling with wet hands prohibited
 Compulsory	Compulsory actions
 Unplug First	Disconnect power source

Wi-Fi Router, Battery, USIM Card, AC Charger & Micro USB Cable

DANGER



Compulsory

Use SoftBank specified battery, AC Charger or Micro USB Cable only.

Use of non-specified accessories may cause battery to leak, overheat, rupture or ignite; AC Charger may overheat, ignite or malfunction.



Do Not Disassemble

Do not disassemble, modify or solder Wi-Fi router or related hardware.

May cause fire, injury, electric shock or malfunction. Modifying the Wi-Fi router is a violation of the Radio Act, thus penalties may be imposed.



Avoid Liquids Or Moisture

Do not expose to liquids.

Do not leave Wi-Fi router or related hardware wet after exposure to water, pet urine, etc., and do not insert wet Wi-Fi router into PC. May cause overheating, electric shock, fire, injury or malfunction. Use them in an appropriate place properly.



Prohibited

Do not use or expose Wi-Fi router or related hardware to extreme heat (e.g., near fire or sources of heat, in direct sunlight, inside vehicles, etc.).

May cause warping or malfunction. In addition a portion of the case may heat up, thereby causing burns.



Prohibited

Do not use excessive force to install battery, or insert Micro USB Cable into AC Charger or Wi-Fi router. Confirm battery terminal orientation before installation. Battery may leak, overheat, rupture or ignite.

WARNING



Prohibited

Do not place Wi-Fi router, battery, AC Charger or Micro USB Cable in/on ovens, microwave ovens, pressure cookers, induction stoves or other cooking appliances. May cause battery to leak, overheat, rupture or ignite; or may cause Wi-Fi router, AC Charger or Micro USB Cable to overheat, emit smoke, ignite or malfunction.



Compulsory

Stop using Wi-Fi router near gas stations or places with fire/explosion risk.

Gases may ignite. Using Wi-Fi router near petrochemicals or other flammables may cause fire or explosion.



Prohibited

Do not apply strong shocks or impacts. May cause malfunction.



Compulsory

If any unusual sounds, odors, smoke or other abnormalities occur while using or storing, turn off the PC connected with Wi-Fi router. Continued use may cause fire or electric shock.



Prohibited

Keep liquids (water, pet urine, etc.) and conductive materials (e.g. pencil lead, metal fragments, metal necklaces, hairpins, etc.) away from External Device Port. In addition do not put anything inside of it. May cause short circuit, resulting in fire or malfunction.

CAUTION



Prohibited

Do not place Wi-Fi router on unstable surfaces. Wi-Fi router or related hardware may fall, resulting in injury, malfunction, etc.



Compulsory

Keep Wi-Fi router out of infants' reach. Infants may choke from swallowing Wi-Fi router or related hardware or be injured, etc.



Compulsory

If your child is using Wi-Fi router, explain all instructions and supervise usage. Misuse may cause injury, etc.

Battery

Check battery type on battery label. Properly use and dispose of battery according to type.

Label	Battery type
Li-ion	Lithium-ion

DANGER



Prohibited

Do not throw battery into a fire.
May cause battery to leak, rupture or ignite.



Prohibited

Do not puncture battery with a nail, hit it with a hammer, step on it or subject it to strong impact.
May cause battery to leak, overheat, rupture or ignite.



Prohibited

Do not carry or store conductive materials (e.g. pencil lead, metal fragments, metal necklaces, hairpins, etc.) together with battery.
May cause battery to leak, overheat, rupture or ignite.



Compulsory

If battery fluid gets into eyes, immediately rinse with clean water and consult a doctor. Do not rub eyes.
Failing to do so may result in loss of eyesight.

WARNING



Compulsory

If battery fluid gets on your skin or clothing, immediately stop Wi-Fi router use and rinse with clean water.

Battery fluid may harm your skin.



Compulsory

If battery is not fully charged even after specified charging time, stop charging.

Battery may leak, overheat, rupture or ignite.



Compulsory

If you notice an unusual odor, overheating, discoloration, deformation, etc. while using, charging or storing battery, remove it from Wi-Fi router and keep it away from fire. Be careful not to burn or injure yourself.
Continued use may cause battery to leak, overheat, rupture or ignite.

CAUTION



Compulsory

Do not dispose of battery as municipal waste.

Bring used battery to a SoftBank Shop or recycling center after insulating the terminals with tape. Be sure to observe local regulations on battery disposal.

Wi-Fi Router

WARNING



Prohibited

Do not sit down with Wi-Fi router in your trousers pocket.

Excess weight may damage Display, battery or other parts resulting in overheating, fire or injury.



Compulsory

Power off nearby electronic devices employing high precision control systems or weak signals.

May cause electronic malfunctions, etc.

*Be especially careful near the following devices:

Hearing aids, implanted cardiac pacemakers, implanted defibrillators and other electronic medical equipment; fire alarms, automatic doors and other automatic control devices



Compulsory

Because Wi-Fi router radio waves may impair aircraft operations, please power off Wi-Fi router while aboard. When Wi-Fi router use aboard aircraft is allowed, please follow instructions of airline personnel.



Compulsory

If thunder is heard while outdoors, turn power off; find cover.

There is a risk of lightning strike or electric shock.

CAUTION



Prohibited

Do not use Wi-Fi router in a vehicle if it affects in-vehicle electronic devices.

Wi-Fi router use in some types of vehicles may, in some rare cases, affect in-vehicle electronic devices and interfere with safe driving.



Compulsory

If you experience any skin irritation associated with Wi-Fi router use, discontinue Wi-Fi router use and consult a doctor.

Metal and other materials may cause skin irritation, rashes, or itchiness depending on your physical condition.

Parts	Material/Finishing
Unit	PC+ABS
Display Panel	Polycarbonate
Function Key	PC+TPU
Memory Card Slot Cover, External Antenna Port Cover	PC+TPU



Prohibited

Keep Wi-Fi router away from magnetic cards, etc.

Data on bank cards, credit cards, telephone cards, floppy disks, etc. may be lost.



Compulsory

Wi-Fi router may become hot while in use, especially at high temperature.

Prolonged contact with skin may cause burn injuries.

USIM Card & Memory Card

CAUTION



Prohibited

Do not insert objects other than Memory Card into Memory Card Slot.
May cause overheating, electric shock or malfunction.



Prohibited

Do not shake, subject to shocks or remove Memory Card while writing or reading Memory Card data.
May cause data loss or malfunction.



Prohibited

Do not use Memory Card other than specified one.
May cause data loss or malfunction. Wi-Fi router supports Memory Card with a storage capacity of up to 32 GB.



Prohibited

Do not use excessive force when inserting or removing USIM Card.
May cause malfunction. Be careful not to injure hands or fingers when removing USIM Card.



Prohibited

Do not use USIM Card other than specified one.
May cause data loss or malfunction.

AC Charger & Micro USB Cable

WARNING



Prohibited

Do not cover or wrap with clothing or bedding during charging.
Heat may build up resulting in fire or malfunction.



Compulsory

Use only the specified voltage.
Non-specified voltages may cause fire or malfunction.
AC Charger: AC 100 V-240 V Input
Do not use power adapters.
Using AC Charger with step-up/step-down transformer may cause fire, electric shock or malfunction.



Unplug First

Grasp plug and unplug AC Charger from outlet before extended periods of Wi-Fi router disuse.
Failing to do so may cause electric shock, fire or malfunction.



Unplug First

If liquid (water, pet urine, etc.) gets into AC Charger, immediately grasp plug and unplug AC Charger from outlet.
Failing to do so may cause electric shock, smoke emission or fire.



Compulsory

If dust accumulates on AC Charger plug, grasp plug and unplug AC Charger from outlet and wipe with a dry cloth.
Failing to do so may cause fire.



Compulsory

When plugging AC Charger into outlet, keep conductive materials (pencil lead, metal fragments, necklaces, hairpins, etc.) away from AC Charger prongs/Micro USB Cable plugs; plug AC Charger firmly into outlet.
Failing to do so may cause electric shock, short circuit, fire, etc.



No wet hands

Do not plug/unplug AC Charger with wet hands.
May cause electric shock or malfunction.



Prohibited

If thunder is heard, do not touch AC Charger.
May cause electric shock.

CAUTION



Unplug First

Firmly hold plug and unplug AC Charger from outlet before cleaning.

Failing to do so may cause electric shock.



Compulsory

Do not unplug AC Charger by pulling the cord. Firmly hold plug and unplug AC Charger.

Pulling the cord may damage the cord resulting in electric shock or fire.



Prohibited

When AC Charger is connected to an outlet, do not pull on cord or otherwise subject AC Charger to strong shock.

May cause injury or malfunction.



Prohibited

Do not touch Wi-Fi router with sweaty hands or place it into a sweaty clothes pocket.

Sweat and humidity may corrode internal components of Wi-Fi router and cause overheating or malfunction.



Prohibited

Do not pull, bend with excessive force or twist Micro USB Cable.

Do not damage or modify Micro USB Cable. Do not place objects on Micro USB Cable.

Do not expose Micro USB Cable to heat; avoid heaters.
Damage to Micro USB Cable may cause electric shock, overheating or fire.

Electronic Medical Equipment

CAUTION

This section is based on “Guidelines on Safeguarding Medical Equipment from Electromagnetic Waves from Mobile Phones and Other Devices” (Electromagnetic Compatibility Conference Japan), and “Research Report on the Influence of Electromagnetic Waves on Medical Equipment” (Association of Radio Industries and Businesses, March 2001).



Compulsory

Keep Wi-Fi router at least 22 centimeters away from implanted cardiac pacemaker or implanted defibrillator.
Radio waves may interfere with implanted pacemakers or defibrillators.



Compulsory

If you intend to use electronic medical equipment other than implanted pacemaker/defibrillator outside medical facilities, consult the vendor on radio wave effects.
Radio waves may interfere with electronic medical equipment.



Compulsory

Observe the following in medical institutions. Radio waves from Wi-Fi router may affect electronic medical equipment.

- Do not enter an operating room or an Intensive or Coronary Care Unit while carrying Wi-Fi router.
- Power off Wi-Fi router in hospitals.
- Even in lobbies or other places where Wi-Fi router use is permitted, turn off Wi-Fi router near electronic medical equipment.
- Obey medical facility rules on use.



Compulsory

Do not use in crowds/trains. People with implanted pacemaker/defibrillator may be near.

Radio waves may interfere with the operation of implanted cardiac pacemakers or implanted defibrillators.

Usage Basics

- Wi-Fi router transmissions may be disrupted inside buildings, tunnels, or underground, or when moving into/out of such places.
- Use Wi-Fi routers without disturbing others. Theaters and public transportation systems may or may not allow use of Wi-Fi router.
- Wi-Fi routers are radios as stipulated by the Radio Law. Under the Radio Law, Wi-Fi router must be submitted for inspection upon request.
- Files may be lost or damaged in the following situations. SoftBank Mobile is not liable for damages incurred due to lost or altered information. To minimize damages, back up data and store separately.
 - When using Wi-Fi router incorrectly.
 - When affected by static electricity or electrical noise.
 - Powering Wi-Fi router off while in use...
 - When Wi-Fi router breaks down or is submitted for repair.
- The Ordinance of the Ministry Specifying Goods and Technologies Pursuant to Provisions of the Appended Table 1 of the Export Trade Control Order and the Appended Table of the Foreign Exchange Order documents might be needed depending on what kinds of devices are taken overseas, but if Wi-Fi router is taken abroad on trips or short business trips for personal usage, they essentially are not needed when bringing it back in. However, if Wi-Fi router is used by other individuals or handed over to them, an export license may be required. In addition, if Wi-Fi router is taken to countries (Cuba, North Korea, Iran, Sudan and Syria) which are subject to U.S. government stipulated export restraints, then U.S. government export licenses might be required. For details on the particulars of regulations for export laws and ordinances and procedures visit the Ministry of Economy, Trade and Industry's Security Export Control Division's website.

- Do not use Wi-Fi router in the proximity of areas where explosive materials are handled. An explosion may be induced. In addition, explosive devices might be affected.
- Wi-Fi router USIM Card cannot be used with some mobile devices (including SoftBank models).
- If Wi-Fi router is used for a long time or while charging, Wi-Fi router may become hot.
- Prolonged contact with skin may cause burn injuries.
- AC Charger may become hot while charging.

Aboard Aircraft

- Radio waves may impair aircraft operations; power off Wi-Fi router while aboard aircraft. If Wi-Fi router use is allowed, follow the instructions of airline personnel.

Handling

- Do not expose Wi-Fi router to rain, snow, or high humidity. Wi-Fi router is not waterproof.
- Avoid extreme temperatures/direct sunlight/dusty areas.
- Do not drop or subject Wi-Fi router to shocks.
- Clean Wi-Fi router with soft dry cloth. In addition do not use alcohol nor thinners since their use may fade colors and lettering.

Wi-Fi (WLAN)

■ Precautions

- Do not use Wi-Fi (WLAN) near magnetic devices such as electrical appliances or AV/OA devices, or where there are electromagnetic waves.
 - Magnetism or electrical noise may increase noise or disable communications (especially when using a microwave oven).
 - Wi-Fi router use near TV, radio, etc., may cause interference.
 - The target access point may not be detected correctly if there are multiple access points nearby.
- Wireless Frequencies & Modulations
Wi-Fi frequency information: Inside Wi-Fi router battery cover.

2.4DS4/OF4

- 2.4: 2400 MHz range
FH/OF: DSSS or OFDM modulation
4: Maximum interference range of 40 m
■■■■: Utilizes 2400 - 2483.5 MHz band with mobile device

- Available channels vary depending on the country.
 - For use aboard aircraft, contact the airline beforehand.
- If using WLAN abroad, confirm usable frequency, laws and regulations in that country.

2.4 GHz Device Cautions

Wi-Fi router operates in the same frequency band used by industrial, scientific, consumer and medical equipment including microwave ovens, premises radio stations for identifying mobile units used in the manufacturing lines of plants (radio stations requiring a license), specified low power radio stations (radio stations requiring no license) and amateur radio stations (radio stations requiring a license).

1. Before using Wi-Fi router, confirm that on-site wireless base stations for identifying mobile units, specified low power radio stations and amateur radio stations are not being operated nearby.
2. If Wi-Fi router causes disruptive radio interference to on-site wireless base stations for identifying mobile units, immediately change frequency band, stop use, move to another location to avoid crosstalk (e.g. wall partitions, etc.).

■ WLAN Usage Security Precautions

Using Wi-Fi router without setting security increases risk of data interception. Wi-Fi router security is set by default. SoftBank recommends changing default security settings to enhance data safety. For more information on security settings, see this guide or Wi-Fi device guide.

- For assistance with security settings, contact SoftBank Customer Support P.7-3).
- SoftBank cannot be held liable for WLAN security issues.

ZTE, ZTE中興 and ZTE logo are trademarks or registered trademarks of ZTE Corporation in China/other countries.
Copyright © 2011 ZTE Corporation. All rights reserved.

SOFTBANK, SOFTBANK's equivalent in Japanese and the SOFTBANK logo are registered trademarks or trademarks of SOFTBANK CORP. in Japan and other countries.

Microsoft®, Windows®, Internet Explorer, Windows Vista® are registered trademarks of Microsoft Corporation in the United States/other countries. Microsoft Windows Operating System is indicated in its abbreviated form as Windows.

Apple and "Apple" logos (Mac, Mac OS, Macintosh, QuickTime) are trademarks of Apple Inc. in the United States/other countries.

Wi-Fi®, Wi-Fi Alliance®, Wi-Fi Certified®, WPA™, WPA2™, Wi-Fi Protected Setup™, and the Wi-Fi Protected Setup logo are trademarks or registered trademarks of the Wi-Fi Alliance.

PlayStation, PS3 and PSP are trademarks or registered trademarks of Sony Computer Entertainment Inc.

Wii, Nintendo DS, Nintendo DS Lite, Nintendo DSi and Nintendo DSi LL are registered trademarks of Nintendo.
Nintendo 3DS and Nintendo Wi-Fi Connection are trademarks of Nintendo.

The names of the companies, products and services used in this guide are registered trademarks or trademarks of the respective companies.



Getting Started	1-2
Package Contents.....	1-2
Parts & Functions.....	1-3
USIM Card	1-5
Memory Card.....	1-7
Battery	1-8

Package Contents

The following items are included in the package.
Please confirm package contents before use.
Contact SoftBank Customer Support (P.7-3) for missing items.



007Z

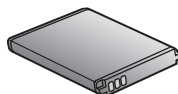

Battery

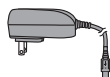

AC Charger

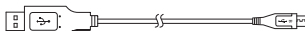

Micro USB Cable

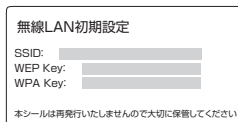

WLAN Initialization Sticker

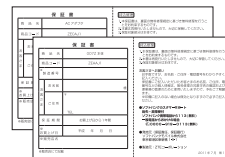
Quick Start Guide
(Japanese)

Warranty (unit, AC Charger)

- This Wi-Fi router accepts microSD™/microSDHC™ Card (sold separately). Purchase one to use Memory Card functions.
- Keep Warranty in a safe place.

Parts & Functions

Part Names & Functions

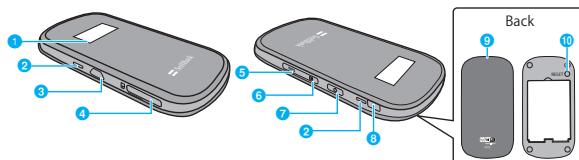

- 1 Display
Wi-Fi router status appears. See "Display" (P.1-4).
- 2 Ventilation Port
- 3 External Device Port
Connect AC Charger or Micro USB Cable here.
- 4 Memory Card Slot
- 5 WPS Key
 - Long Press to enable/disable Wi-Fi.
Connecting Wi-Fi router to a PC via Micro USB Cable automatically enables Wi-Fi.
When Wi-Fi is disabled, press any key to enable Wi-Fi.
 - With WLAN on, press and hold for WPS (Wi-Fi Protected Setup); adjust settings for WPS compatible Wi-Fi devices. See "Connecting WPS Supported Wi-Fi Devices" (P.2-8).
Security set to WEP by default; use SoftBank 007Z Utility to set WPS. See "Activating SoftBank 007Z Utility" (P.5-2).
- 6 CONNECT Key
 - Long Press to toggle connect/disconnect.
 - Press and hold to toggle Always On/Manual.
Setting appears on Display.

- 7 Power Key
Toggle power on/off. Power on to enable WLAN; connects to Internet automatically.
- 8 External Antenna Port
Attach External Antenna* here.
*SoftBank Mobile does not offer nor support External Antenna.
- 9 Battery Cover
- 10 RESET Key
 - Press to reset settings to default.

Display

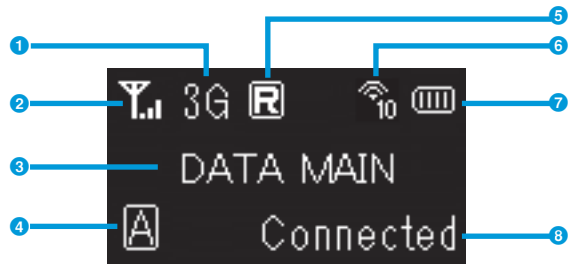

- 1 Connection Status
 - 3G: Connected Network
- 2 Signal Strength
 - \Leftrightarrow : Strong \Leftrightarrow Weak
- 3 Status Notifications
Battery charging or WPS connection status.
See "Status Notifications" (P.1-5)
- 4 Internet Connectivity
Default : **A**
Press and hold CONNECT Key to toggle setting:
 - **A**: Always On
 - **M**: Manual
- 5 Roaming Status
Appears when roaming. Packet Communications charges may be high when roaming.
- 6 Connected Wi-Fi devices
 - **0**: No Wi-Fi devices connected
 - **X**: Wi-Fi disabled

- 7 Battery Strength
 - \Rightarrow : Full \Rightarrow Empty
 - Blinking: Battery exhausted
 - \Rightarrow \Rightarrow \Rightarrow \Rightarrow : Charging

- 8 Internet Connectivity
 - Connected
 - Disconnected

- If Wi-Fi router is not used for a while, Display turns off automatically. Press any key to illuminate Display.
- Leaving Wi-Fi router idle (no transmissions/battery fully charged) activates Sleep mode and ends Internet connection. Press any key to cancel Sleep mode and re-establish a connection.

Status Notifications

These notifications may appear on Wi-Fi router:

Display	Status
	Charging (Power Off)
WPS Processing	Configuring WPS connection
WPS Succeed	WPS connection established
WPS Failed	WPS connection failed
Connecting	Attempting to establish Internet connection
No Service	Wi-Fi router is outside service area
Insert USIM	USIM Card is not installed
Invalid USIM	Invalid USIM is installed
Enter PIN	PIN entry required in SoftBank 007Z Utility
Enter PUK	PUK entry required in SoftBank 007Z Utility
SIM Lock	USIM Card is locked
Low Battery	Charge battery now
DATA MAIN	Wi-Fi router is in Unlimited Data Discount Area
DATA SUB	Wi-Fi router is in Unlimited Data Discount Sub Area

USIM Card

USIM Card is the property of SoftBank Mobile. The IC chip contains customer information including phone number. USIM Card must be installed for use. See USIM Card user guide (Japanese).

USIM Card Installation

- 1 Power off
- 2 If AC Charger or Micro USB Cable is connected, remove it
- 3 Remove Cover
- 4 Lift battery ① and remove it ②
- 5 Insert USIM Card into USIM Card Slot with IC chip down

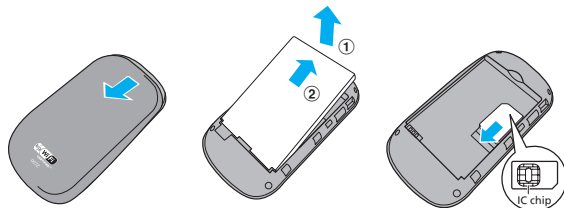

- 6 Confirm USIM Card installation

1

- 7** With label up, ③ slide forward, ④ press down to insert

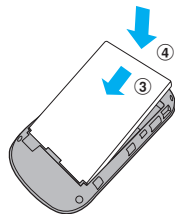

- 8** Replace Cover



Removing USIM Card

- 1** Power off
2 If AC Charger or Micro USB Cable is connected, remove it
3 Remove Cover
4 Lift battery ① and remove it ②
5 Slide USIM Card out and remove it from USIM Card Slot

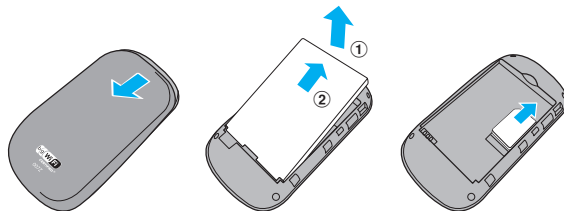

- 6** With label up, ③ slide forward, ④ press down to insert
- 7** Replace Cover

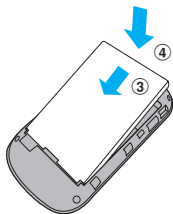

- Avoid touching the IC chip; may cause damage. Forcibly inserting/removing USIM Card may damage it.
- Be careful not to lose removed USIM Card.
- Prevent children from accidentally swallowing USIM Card.
- If IC chip is dusty, clean with a soft cloth.

Memory Card

Wi-Fi router accepts microSD™/microSDHC™ up to 32GB. SoftBank does not guarantee compatibility with all microSD™/microSDHC™ cards.

Memory Card Installation

- 1** Open Memory Card Slot Cover as shown
- 3** Replace Memory Card Slot Cover



- 2** With contacts down, insert Memory Card until it clicks



Removing Memory Card

- 1 Open Memory Card Slot Cover as shown
- 2 Push Memory Card lightly until it clicks; when it pops out, remove it
- 3 Replace Memory Card Slot Cover



- Do not insert USIM Card or Memory Card with excessive force. May cause damage. Do not misplace a removed Memory Card.

Battery

Inserting Battery

Insert battery before use. For battery installation steps, see "USIM Card" (P.1-5).

Charging Battery

Battery is not charged fully out of the box. Charge battery fully before using Wi-Fi router.

AC Charger

- 1 Insert AC Charger USB micro plug into Wi-Fi router External Device Port
- 2 Plug AC Charger prongs into AC 100 V outlet

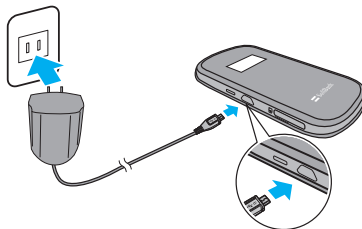

USB Charger

- 1 Insert Micro USB Cable micro plug into Wi-Fi router External Device Port**
- 2 Insert Micro USB Cable plug into PC USB port**
 - Connecting Wi-Fi router to PC for the first time automatically activates driver installer. See P.3-5 or P.3-6.

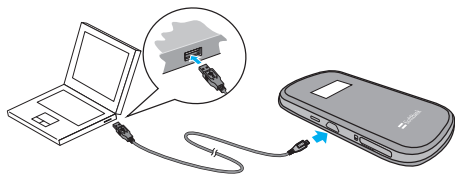

- USB charging may be unavailable depending on modem (battery) temperature.

Battery Strength

Battery Strength indicator appears at the top of Display. If battery becomes low, indicator flashes. See "Display" (P.1-4)

Charging Precautions

When charging battery, note the following:

- Battery must be installed to charge it.
- Always use specified AC Charger or Micro USB Cable.
- Battery discharges even if Wi-Fi router is not in use. Charge after long periods of disuse.
- Approximate Charging Time/Operating Time

Charging Time ¹	Continuous Operating Time ²	Continuous Communication Time ²
AC Charger: 4 hours USB Charger: 6 hours	130 hours	4 hours

¹Varies by ambient temperature, battery usage, etc.

²Varies by environment, signal conditions, etc.

- Replace battery if operating time shortens noticeably.

Using Wi-Fi (WLAN)	2-2
WLAN	2-2
Connecting Wi-Fi Devices via WLAN	2-2
Connecting Windows	2-8
Connecting Mac	2-11

WLAN

Wi-Fi router supports IEEE 802.11b/g/n standards. Connect Wi-Fi devices (PC, game console, etc.) via Wi-Fi for wireless data transfers.

Wi-Fi router supports Wi-Fi Protected Setup (WPS), which easily configures Wi-Fi connection settings on any WPS compliant Wi-Fi device.

Enter Wi-Fi router's SSID and WEP keys to connect non-WPS compliant Wi-Fi devices. See WLAN Initialization Sticker for SSID and WEP keys.

This section describes setup operations First connections to establish initial Wi-Fi connection to Nintendo DS series*, PSP (PlayStation Portable), Wii, PS3 (PlayStation 3), WPS compatible devices, PC and MAC.

*Nintendo DS series is generic name of Nintendo 3DS/DSi LL/DSi/DS Lite/DS.

- These settings should be performed the first time Wi-Fi router is connected to another Wi-Fi device. Thereafter, simply activate WLAN to automatically connect Wi-Fi router to a Wi-Fi device (WAN Connection Mode set to Always On).
- Change WLAN settings as required. See "Settings" (P.5-2).
- For added security, change default SSID or WEP Key.
- Use Wi-Fi router to connect up to ten Wi-Fi devices simultaneously.

Connecting Wi-Fi Devices via WLAN

Connecting Nintendo DS

This guide describes operations using software compatible with Nintendo Wi-Fi Connection for Nintendo DS series*.

*Connection verification for 3DS/DS Lite/DS is completed. All screenshots and operations based on Nintendo DS Lite.

- Make sure Wi-Fi router Security (Encrypt Type) is set to WEP ("Security" (P.5-10)). Note that changing Security settings ends current Wi-Fi device connections.
- Confirm Wi-Fi router is connected to Internet. Internet connection is required to establish Wi-Fi connections.

1 Power on Wi-Fi router

Activate WLAN for an Internet connection.

- WAN Connection Mode is set to Always On by default. Press CONNECT Key or connect Wi-Fi router to PC and use SoftBank 007Z Utility to change it to Manual. See "Internet Connectivity" (P.5-21).

2 On Nintendo DS, Activate Nintendo Wi-Fi Connection, Wi-Fi appears

- For Nintendo DSi, from the menu, touch 本体設定, and then インターネット.
- For Nintendo 3DS, from the HOME menu, touch 本体設定, and then インターネット設定.
- For the operating method, refer to each software manual.

3 Touch **Wi-Fi**接続先設定

- Nintendo DSi: 接続設定
- Nintendo 3DS: インターネット接続設定



4 Touch **未設定**

- Nintendo 3DS: 接続先の登録 → 自分で設定する

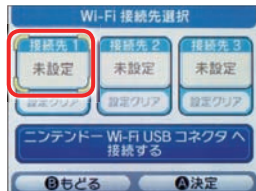

5 Touch アクセスポイントを検索



6 Select Wi-Fi router SSID (*****)

- See Initialization Sticker for Wi-Fi router SSID.
- If default SSID has been changed: Select current SSID.

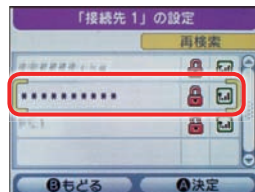

7 Enter WEP Key → 決定

- See Initialization Sticker for WEP.

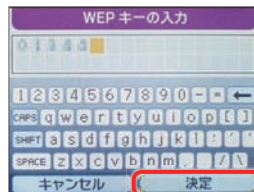

8 Touch はい

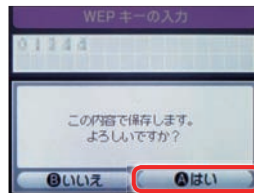

- Nintendo 3DS: OK

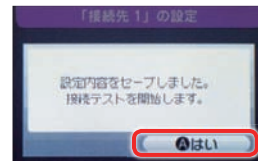

9 Touch はい

- Nintendo 3DS: OK



Connection Test starts. Devices connect and 接続に成功しました appears. Connected Wi-Fi device count on Wi-Fi router Display increases by one (e.g.  → ).

Connecting PSP

Screenshots/operations are based on PSP-2000/PSP-3000, with WLAN security set to WEP.

Screenshots/operations may vary for PSP-1000* or when security is not set to WEP. See PSP User's Guide.

*Some procedures may vary for PSP-1000 system software earlier than version 1.52.

1 Wi-Fi router: Activate WAN Connection Mode

- WAN Connection Mode is set to Always On by default. Press CONNECT Key or connect Wi-Fi router to PC and use SoftBank 007Z Utility to change it to Manual. See "Internet Connectivity" (P.5-21).

2 PSP: Slide WLAN Switch to On

3 In PSP Home menu, select **Settings** → **Network Settings** →



4 Select **Infrastructure Mode** → ○

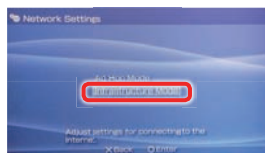

5 Select **New Connection** → ○

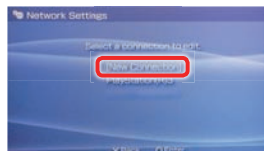

- PSP-1000: Enter connection name → ▷.

6 Select **Scan** → ▷

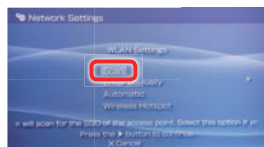

7 Select Wi-Fi router SSID (******)

- See Initialization Sticker for Wi-Fi router SSID.
- If default SSID has been changed: Select current SSID → ○.

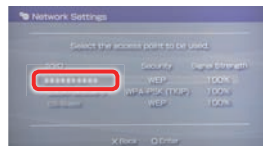

8 Confirm SSID → ▷

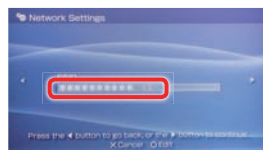

9 Select **WEP** → ▷



10 Press ○ → Enter WEP Key → ▷

- See Initialization Sticker for WEP.

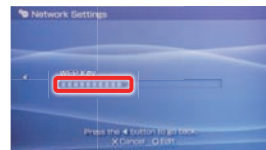

11 Select **Easy** → ▷

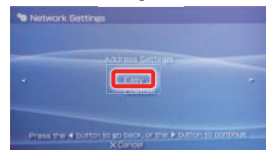

12 Confirm name → ▷

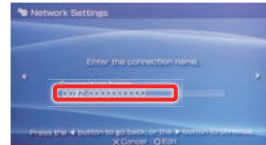

- PSP-1000: Skip ahead to Step 13.

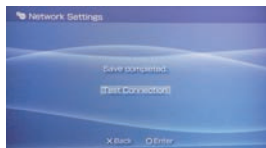

13 Confirm settings →▷**14** Press ○**15** Press ○**16** Connection test starts

When complete, test results appear.



Connected Wi-Fi device count on Wi-Fi router Display increases by one (e.g.  → ).

Connecting Wii

Operations are based on WEP.
Operations may vary when security is not set to WEP. See Wii User's Guide.

1 Wi-Fi router: Activate WAN Connection Mode

- WAN Connection Mode is set to Always On by default. Press CONNECT Key or connect Wi-Fi router to PC and use SoftBank 007Z Utility to change it to Manual. See "Internet Connectivity" (P.5-21).

2 In Wii menu, select **Wii**

3 Select **Wii**本体設定

4 Select ▶

Wii本体設定2 appears.

5 Select インターネット

6 Select 接続設定

7 Select 未設定

8 Select **Wi-Fi**接続

9 Select アクセスポイントを検索

10 Select **OK**

11 Select Wi-Fi router SSID (*****)

- See Initialization Sticker for Wi-Fi router SSID.
- If default SSID has been changed: Select current SSID.

12 Enter WEP key → Enter

- See Initialization Sticker for WEP.

13 Select **OK**

14 Select OK

Connection test starts. When complete, 接続に成功しました appears.

Connected Wi-Fi device count on Wi-Fi router Display increases by one (e.g.  → ).

Connecting PS3

Screenshots/operations are based on WEP.
Screenshots/operations may vary when security is not set to WEP. See PS3 User's Guide.

1 Wi-Fi router: Activate WAN Connection Mode

- WAN Connection Mode is set to Always On by default. Press CONNECT Key or connect Wi-Fi router to PC and use SoftBank 007Z Utility to change it to Manual. See "Internet Connectivity" (P.5-21).

2 In PS3 Home menu, select **Settings** → **Network Settings** → Internet Connection Settings



3 Select **Yes** → ○

4 Select **Easy** → ▷



5 Select **Wireless** → ▷



6 Select **Scan** → ▷



7 Select Wi-Fi router SSID (*****)

- See Initialization Sticker for Wi-Fi router SSID.
- If default SSID has been changed: Select current SSID.



8 Confirm SSID → ▷



9 Select **WEP** → ▷



10 Press ○. Enter WEP key → ▷

- See Initialization Sticker for WEP.



11 Confirm settings → ○

- Settings are saved.



12 Press ○

The connection test starts. When complete, test results appear.



Connected Wi-Fi device count on Wi-Fi router Display increases by one (e.g. 0 → 1).

Connecting WPS Supported Wi-Fi Devices

WPS button is unavailable if WEP is set. WEP is set by default, use utility to change WLAN security encryption setting.

See "Changing Security" (P.5-20).

1 Wi-Fi router: Activate WAN Connection Mode

- WAN Connection Mode is set to Always On by default. Press CONNECT Key or connect Wi-Fi router to PC and use SoftBank 007Z Utility to change it to Manual. See "Internet Connectivity" (P.5-21).

2 Turn on the WLAN functions → Prepare for WPS settings as required

3 Power on Wi-Fi router



"WPS Processing" appears on Display.

4 Connect Wi-Fi devices via WPS

When complete, "WPS Succeed" appears.

- Operations vary depending on Wi-Fi devices.

5 If other settings are required with Wi-Fi devices, follow the onscreen instructions

Connected Wi-Fi device count on Wi-Fi router Display increases by one (e.g.  → .

Connecting Windows

All screenshots and procedures based on WEP.

Windows 7

1 Wi-Fi router: Activate WAN Connection Mode

- WAN Connection Mode is set to Always On by default. Press CONNECT Key or connect Wi-Fi router to PC and use SoftBank 007Z Utility to change it to Manual. See "Internet Connectivity" (P.5-21).

2 Turn on PC WLAN function

3 In Start menu, click **Control Panel** → Network and Internet → **Network and Sharing Center**

4 Click **Connect to a network**

5 Click SSID (******) → **Connect**

- See Initialization Sticker for Wi-Fi router SSID.
- If default SSID has been changed: Select current SSID.



6 Enter Security key in Security key field, click **OK**

- See Initialization Sticker for security key.



Connected Wi-Fi device count on Wi-Fi router Display increases by one (e.g.  → ).

Windows Vista

1 Wi-Fi router: **Activate WAN Connection Mode**

- WAN Connection Mode is set to Always On by default. Press **CONNECT** Key or connect Wi-Fi router to PC and use SoftBank 007Z Utility to change it to Manual. See "Internet Connectivity" (P.5-21).

2 Turn on PC WLAN function

3 In Start menu, click **Control Panel** → **Network and Internet** → **Network and Sharing Center**

4 Click **Connect to a network**

5 Click Wi-Fi router SSID (******) → **Connect**

- See Initialization Sticker for Wi-Fi router SSID.
- If default SSID has been changed: Select current SSID.

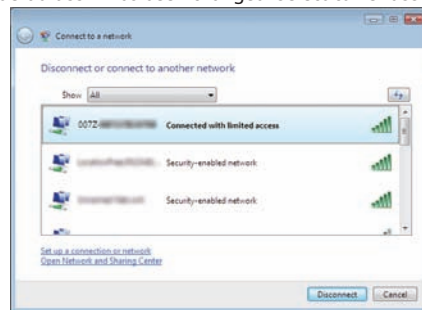

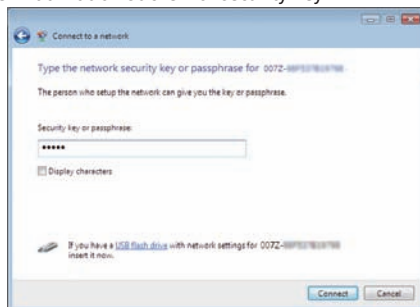

- 6** Enter Security key in Security key or passphrase field, click **Connect**

- See Initialization Sticker for security key.



- 7** Click **Close**

Connected Wi-Fi device count on Wi-Fi router Display increases by one (e.g.  → ).

Windows XP

- 1** Wi-Fi router: Activate WAN Connection Mode

- WAN Connection Mode is set to Always On by default. Press CONNECT Key or connect Wi-Fi router to PC and use SoftBank 007Z Utility to change it to Manual. See "Internet Connectivity" (P.5-21).

- 2** Turn on PC WLAN function

- 3** In Start menu, click **Control Panel** → **Network and Internet** → **Network and Sharing Center**

- 4** Click **Wireless network connection** → Network task from Use displayed wireless network

- 5** Click Wi-Fi router SSID (******) → **Connect**

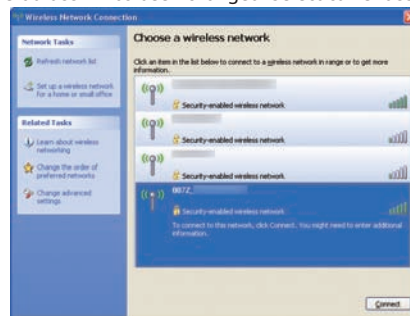

- See Initialization Sticker for Wi-Fi router SSID.
- If default SSID has been changed: Select current SSID.



6 In Network key, confirm Network key field, enter Security key → **Connect**

- See Initialization Sticker for security key.



Connected Wi-Fi device count on Wi-Fi router Display increases by one (e.g.  → ).

Connecting Mac

Screenshots/operations are based on WEP, Mac OS X 10.6.

1 Wi-Fi router: Activate WAN Connection Mode

- WAN Connection Mode is set to Always On by default. Press CONNECT Key or connect Wi-Fi router to PC and use SoftBank 007Z Utility to change it to Manual. See "Internet Connectivity" (P.5-21).

2 From Apple menu, click **System Preferences** → **Network**

3 Click **AirPort** → Turn AirPort On to turn WLAN function on

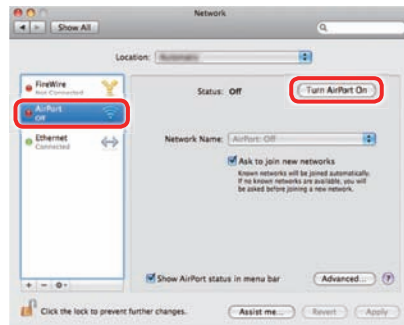

4 From Network Name pulldown list, select Wi-Fi router SSID (*****)

- See Initialization Sticker for Wi-Fi router SSID.
- If default SSID has been changed: Select current SSID.

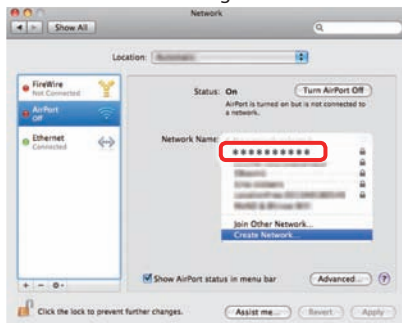



5 Enter security key in Password field → **Remember this network** → **OK**

- See Initialization Sticker for security key.



6 Confirm Network Name is set to SSID (*****)

Connected Wi-Fi device count on Wi-Fi router Display increases by one (e.g.  → ).

Using Micro USB Cable (PC)	3-2
Device Recognition (PC).....	3-2
Software Installation (PC).....	3-2
Connecting to Internet.....	3-7
Device Removal (PC).....	3-8

Device Recognition (PC)

- 1 Insert Micro USB Cable micro plug into Wi-Fi router (USIM Card installed) External Device Port
- 2 Insert Micro USB Cable plug into PC USB Port
PC should recognize Wi-Fi router within a few minutes.

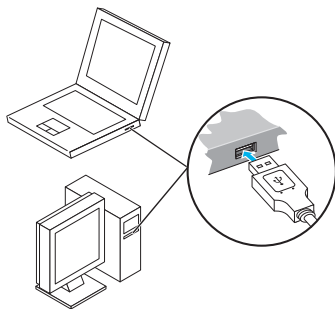

System message appears upon device recognition. Install driver for initial activation. See "Software Installation (PC)" (P.3-2)

- Wi-Fi router may fail if PC enters sleep mode, etc. with it connected. Remove Wi-Fi router before leaving a PC unattended, etc. Wi-Fi router may malfunction if connected before PC starts/restarts. Remove Wi-Fi router before starting or restarting PC.

Software Installation (PC)

Router driver and SoftBank 007Z Utility are saved in advance. For initial activation, they are installed automatically.

- Do not remove Wi-Fi router during installation. May cause installation failure, system malfunction or other system errors.
- Login using administrator privileges.

Driver Installation (Windows 7)

- 1 Power on PC and initiate Windows
- 2 Connect Wi-Fi router to PC via Micro USB Cable
- 3 Installer activates a few seconds after connection
 - If an older version of Utility is already installed a message appears. Remove old version before installation.
 - If installer does not activate automatically, see (P.3-5).
- 4 In AutoPlay, click **Run AutoRun.exe**
- 5 If User Account Control appears, click **Yes**
- 6 設定言語の選択 appears, select 英語 → **OK**

- 7** Welcome to the InstallShield Wizard for SoftBank 007Z Utility dialog box appears. Click **Next**

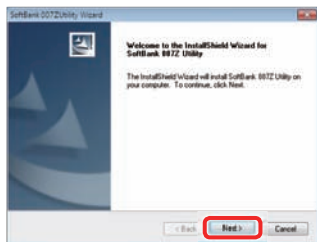

- 8** When dialog box below appears, click **Finish**

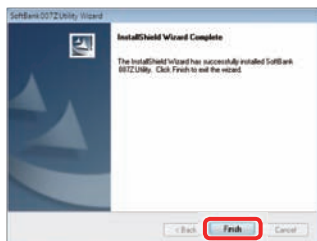

- 9** Utility shortcut icon appears and installation starts in the background. Web browser activates and SoftBank 007Z Utility appears

- Restart PC if it does not function correctly.

Driver Installation (Windows Vista)

- 1** Power on PC and initiate Windows
- 2** Connect Wi-Fi router to PC via Micro USB Cable
- 3** Installer activates a few seconds after connection

- If an older version of Utility is already installed a message appears. Uninstall old version before installation.
- If installer does not activate automatically, see (P.3-6).

- 4** In AutoPlay, click **Run AutoRun.exe**
- 5** If User Account Control appears, click **Continue**
- 6** 設定言語の選択 appears, select 英語 → **OK**
- 7** Welcome to the InstallShield Wizard for SoftBank 007Z Utility dialog box appears. Click **Next**

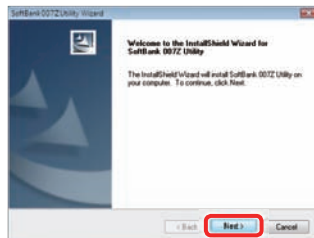

- 8 When dialog box below appears, click **Finish**



- 9 Utility shortcut icon appears and installation starts. Web browser activates and SoftBank 007Z Utility appears

- Restart PC if it does not function correctly.

Driver Installation (Windows XP)

- 1 Power on PC and initiate Windows
- 2 Connect Wi-Fi router to PC via Micro USB Cable
- 3 Installer activates a few seconds after connection

- If an older version of SoftBank 007Z Utility is already installed a message appears. Uninstall old version before installation.
- If installer does not activate automatically, see (P.3-6).

- 4 設定言語の選択 appears, select 英語 → OK
- 5 Welcome to the InstallShield Wizard for SoftBank 007Z Utility dialog box appears. Click **Next**

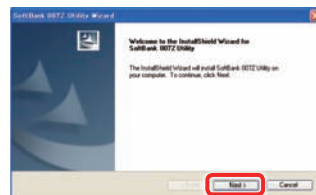

6 When dialog box below appears, click **Finish**

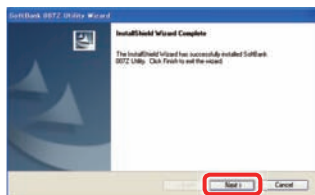

7 Utility shortcut icon appears and installation starts. Web browser activates and SoftBank 007Z Utility appears

- Restart PC if it does not function correctly.

Manual Installation (Windows 7)

If installer fails to start automatically, follow these steps:
 *Always power on PC before connecting Wi-Fi router to PC via Micro USB Cable.

1 In Start menu, click **Computer**

2 Double-click **SoftBank 007Z**

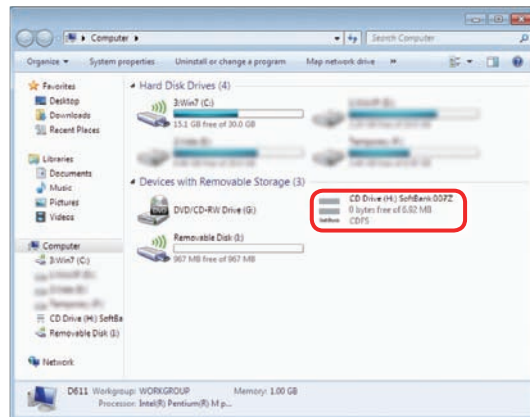

3 If User Account Control appears, click **Yes**

4 設定言語の選択 appears, see "Driver Installation (Windows 7)" (P.3-2) after Step **6**

Manual Installation (Windows Vista)

If installer fails to start automatically, follow these steps:

*Always power on PC before connecting Wi-Fi router to PC via Micro USB Cable.

- 1 In Start menu, click **Computer**
- 2 Double-click **SoftBank 007Z**

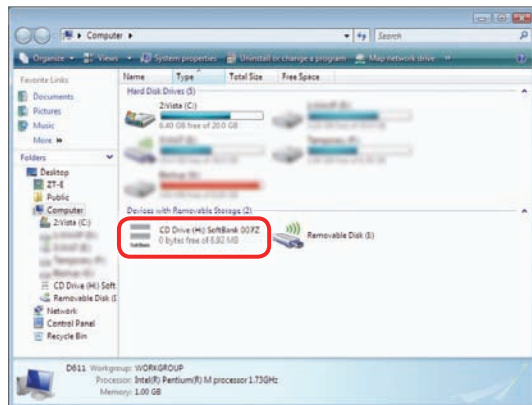

- 3 If User Account Control appears, click **Continue**
- 4 設定言語の選択 appears, see "Driver Installation (Windows Vista)" (P.3-3) after Step 6

Manual Installation (Windows XP)

If installer fails to start automatically, follow these steps:

*Always power on PC before connecting Wi-Fi router to PC via Micro USB Cable.

- 1 In Start menu, click **Computer**
- 2 Double-click **SoftBank 007Z**

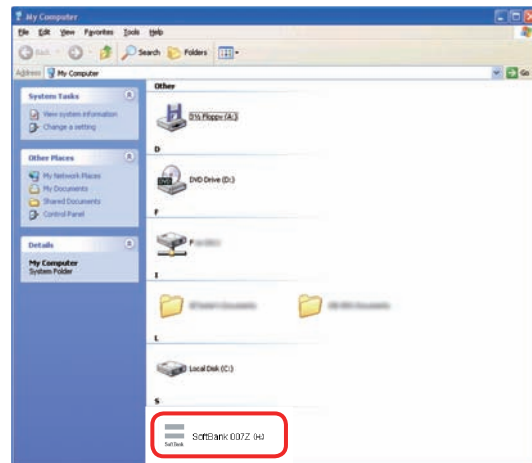

- 3 設定言語の選択 appears, see "Driver Installation (Windows XP)" (P.3-4) after Step 5

Uninstalling Driver

- 1 Select **Start** → **All Programs** → **SoftBank 007Z Utility** → **Uninstall**
- 2 User Account Control appears. Click **Yes**
 - For Windows Vista, click **Continue**.
 - For Windows XP, screen does not appear.
- 3 **Do you want to completely remove the selected application and all of its features?** confirmation appears. Click **Yes**
- 4 **Please remove USB MODEM from PC, before uninstalling!** confirmation appears. Click **Yes** to start uninstallation
- 5 Upon uninstallation, dialog box below appears. Click **Finish** to end uninstallation

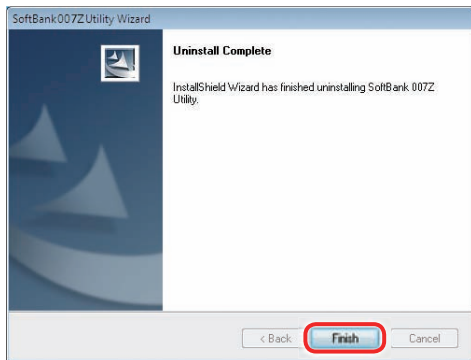

Connecting to Internet

- 1 **Wi-Fi router: Activate WAN Connection Mode**
 - WAN Connection Mode is set to Always On by default. Press CONNECT Key or connect Wi-Fi router to PC and use SoftBank 007Z Utility to change it to Manual. See "Internet Connectivity" (P.5-21).

Device Removal (PC)

- Close SoftBank 007Z Utility before removing Wi-Fi router. Do not remove Wi-Fi router during transmissions.

For Windows 7, exit Utility before removing Wi-Fi router.

- With Memory Card installed, in Task Tray, click  then click Eject Removable Disk. Once Wi-Fi router can be removed safely, remove it.

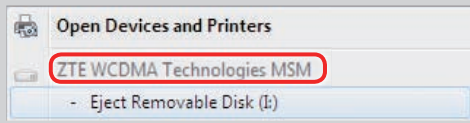

For Windows Vista/Windows XP, click Removable Disk before removing Wi-Fi router.

1 Double-click on Task Tray

- For Windows XP, double-click  in Task Tray.

2 Safely Remove Hardware appears. Select **USB Mass Storage Device** and click **Stop**

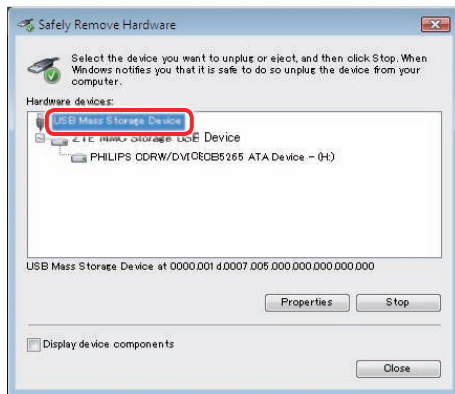

- For Windows XP, USB Mass Storage Device appears.

3 Stop a Hardware device appears. If Wi-Fi router can be safely removed from PC, click **OK**



- 4** When Safely Remove Hardware appears, disconnect the Wi-Fi router

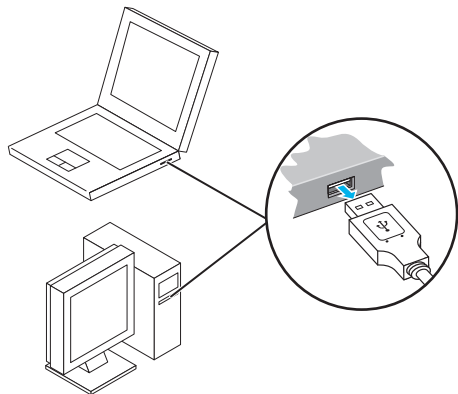

Using Micro USB Cable (Mac)	4-2
Device Recognition (Mac)	4-2
Software Installation (Mac)	4-2
Connecting to Internet	4-4
Device Removal (Mac).....	4-5

Device Recognition (Mac)

Make sure USIM Card is installed in Wi-Fi router, insert Micro USB Cable plug into Wi-Fi router External Device Port. Insert Micro USB Cable plug into Mac USB port. Mac should automatically recognize Wi-Fi router within a few seconds.

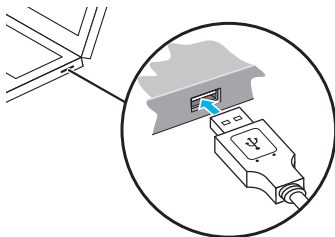

See "Software Installation (Mac)" (P.4-2)

- Wi-Fi router may fail if Mac enters sleep mode, etc. with it connected. Remove Wi-Fi router before leaving a Mac unattended, etc. Wi-Fi router may malfunction if connected before Mac starts/restarts. Remove Wi-Fi router before starting or restarting Mac.

Software Installation (Mac)

All screenshots and procedures based on Mac OS 10.6.

Driver installation

Wi-Fi router driver and SoftBank 007Z Utility are saved in advance. For initial activation, they are installed automatically.

- Do not remove Wi-Fi router during installation. May cause installation failure, system malfunction or other system errors.

1 Power on Mac and initiate Mac

2 Connect Wi-Fi router to Mac via Micro USB Cable

If  icon appears on desktop, double-click it. SoftBank 007Z Utility opens automatically.

3 Double-click **SoftBank 007Z Utility** to start installation.

Dialog box below appears. Click **Continue**

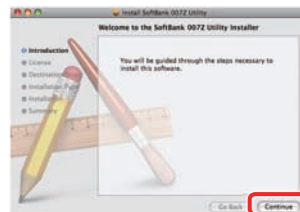

- If an older version of this software, etc. is already installed, uninstall it, then install SoftBank 007Z Utility.
- Make sure that only the latest Utility is installed before use.

4 Standard Install on Macintosh HD dialog box appears. Click **Install**



- "Macintosh HD" is hard disk name. It may vary.

5 Certification appears. Enter Name and Password and click **OK**



6 Installation starts

7 When dialog box below appears, click **Close**

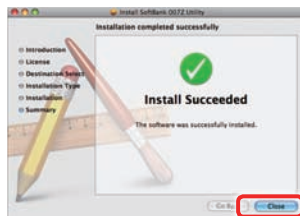

8 Web browser activates and SoftBank 007Z Utility appears

- Restart Mac if it does not function correctly.

Uninstalling Driver

- 1 Click  to open Finder
- 2 Remove **SoftBank 007Z Utility**
 - Double-click ***Uninstall SoftBank 007Z Utility*** in Macintosh HD/application folder.
- 3 Click ***Uninstall***
- 4 Certification appears. Enter Name and Password and click ***OK***
- 5 When uninstallation finishes, click ***Close***
- 6 Restart Mac

- "Macintosh HD" is hard disk name. It may vary.

Connecting to Internet

- 1 **Wi-Fi router: Activate WAN Connection Mode**
 - WAN Connection Mode is set to Always On by default. Press CONNECT Key or connect Wi-Fi router to PC and use SoftBank 007Z Utility to change it to Manual. See "Internet Connectivity" (P.5-21).

Device Removal (Mac)

- Close SoftBank 007Z Utility before removing Wi-Fi router. Do not remove Wi-Fi router during transmissions.

Follow these steps below to remove Wi-Fi router from Mac. Wi-Fi router may be damaged if it is improperly removed.

1 Click  to open Finder

2 In Finder, click  beside SoftBank 007Z

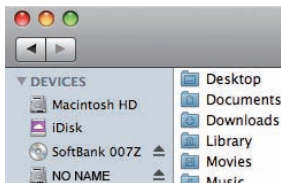

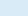
- If Memory Card is installed, first click  card removal icon, then click  beside SoftBank 007Z.

3 Remove Wi-Fi router from Mac

In Finder, if the above icon does not appear, end SoftBank 007Z Utility and remove Wi-Fi router.

Settings.....	5-2
Overview.....	5-2
WLAN & WAN Information	5-3
Advanced Settings.....	5-4
Changing Security	5-20
Internet Connectivity	5-21

Overview

Use SoftBank 007Z Utility to change network settings, etc. Install SoftBank 007Z Utility on a computer to use it. Connect Wi-Fi router to computer via Micro USB Cable or WLAN; use utility software through web browser to change Wi-Fi router settings, etc.

- Using SoftBank 007Z Utility to change Wi-Fi Settings while Wi-Fi router is wirelessly connected to computer, may sever WLAN connection. Reconnect Wi-Fi router to re-establish WLAN connection.

Activating SoftBank 007Z Utility

- 1 Power on computer and connect Wi-Fi router via Micro USB Cable or WLAN**
- 2 On computer desktop, double-click **
Browser activates and SoftBank 007Z Utility opens.
- 3 Change SoftBank 007Z Utility Interface**
To switch language to English, select 言語 → **English**.
- 4 Enter Administrator Password → **Login****
• Administrator Password is "admin" by default. To change it, see "Management" (5-16).

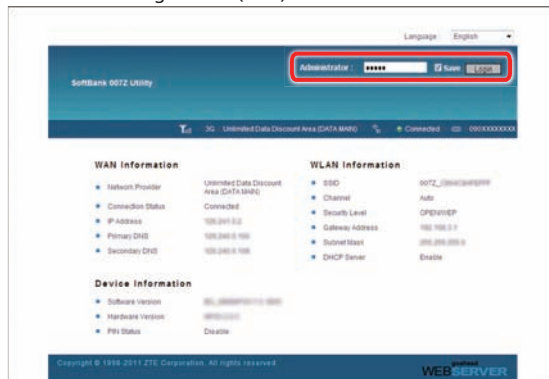

SoftBank 007Z Utility

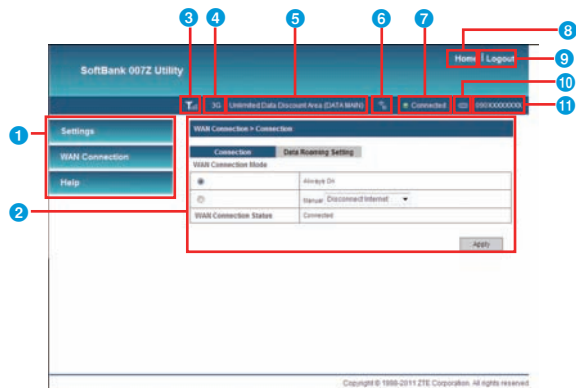

1 Main Menu

Toggle setting pages

2 Settings

Current settings and options

3 Signal Strength

4 Network Type

Connected network type

5 Communication Service

6 Connected Wi-Fi devices

Number of connected Wi-Fi devices

7 Network Connection Status

8 Home

Click to return to Main Menu

9 Logout

End SoftBank 007Z Utility

10 Battery Strength

Full ⇒ Empty

Charging

11 Phone Number

USIM phone number

WLAN & WAN Information

1 In SoftBank 007Z Utility, click **Home**
WLAN and WAN Information appears.



5

Settings

Advanced Settings

- 1 Click **Settings**
- 2 Click item to set/check

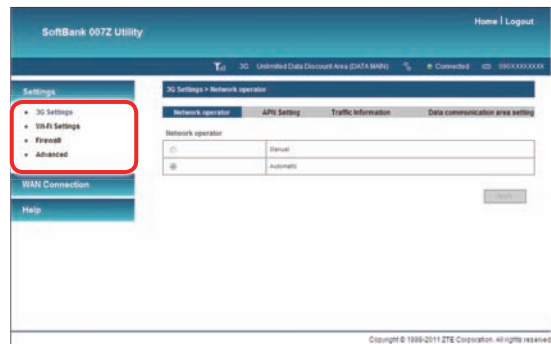

- 3G Settings
Set details regarding Internet connection (P.5-4).
- Wi-Fi Settings
Set details regarding WLAN (P.5-8).
- Firewall
Set details regarding security (P.5-12).
- Advanced
Set details regarding Wi-Fi router (P.5-15).

3G Settings

- 1 Click item to set/check

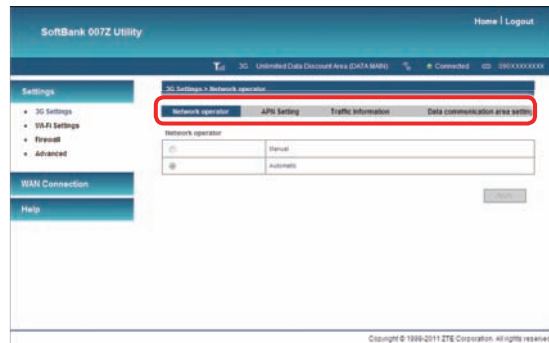

- Network Operator (P.5-5)
- APN Setting (P.5-5)
- Traffic Information (P.5-6)
- Data Communication Area Setting (P.5-7)

Network Operator

Select Network Operator. Setting cannot be changed during Internet use.

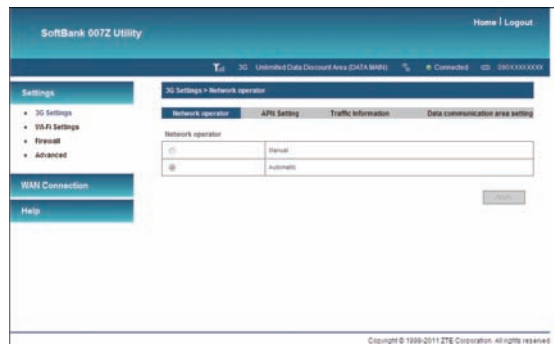

1 Set each item

Item	Used to	Options	Default
Network operator	For Manual: Click Apply → Select network operator → Apply	Automatic, Manual	Automatic

2 Click **Apply**

APN Setting

Select Unlimited Data Discount Area or Sub Area profiles (connection settings). Create, edit and delete profiles.

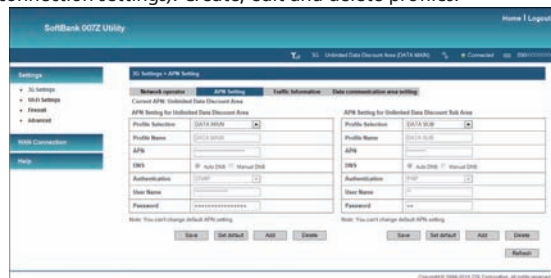

1 Perform these steps for APN Setting for Unlimited Data Discount Area, etc.:

- Create New Profile
Click **Add** and proceed to Step 2.
- Delete Profile
In Profile Selection, select one and click **Delete**.
- Edit Profile
In Profile Selection, select one and proceed to Step 2.
 - Default profiles/those in use cannot be edited/deleted.

2 For Unlimited Data Discount Area and Sub Area, set each item and click **Save**

Item	Used to	Options	Default
Profile Selection	Select profile to edit/delete	Save up to ten profiles including two defaults	-
Profile Name	Enter optional profile name (initial setup)	Alphanumerics/symbols (except \)	-
APN	Set APN	Alphanumerics/symbols (., -) (. and - cannot be used for the first or last characters)	-
DNS	Set DNS	Auto DNS, Manual DNS	Auto DNS
Authentication	Set authentication method	CHAP, PAP	DATA MAIN: CHAP DATA SUB: PAP
User Name	Set user name	Specified by provider	-
Password	Set Password	Specified by provider	-

*DATA MAIN and DATA SUB default profiles cannot be edited/deleted.

- Click **Set default** to save profiles used for connecting to Internet.

3 Click **Apply**

Traffic Information

View data packets and connection times.

1 View each item

Item	Used to	Options	Default
Data Packets	Shows most recent and total transmitted data packets	-	-
Connection Time	Shows most recent and total connection times	-	-
Unit Setting	Select from Byte/Packet	-	Byte

- Shown values are approximates, actual data communication packets and connection times may vary.

2 Perform these operations

■ Refresh Traffic Information

Click **Refresh**.

- Data packets and connection time values are updated.

■ Change Traffic Information Units

In Unit Setting, click **Byte/Packet** → **Apply**.

- Unit is changed.

■ Clear Value

Check box next to item → Click **Clear**.

- Data packets or connection time values are cleared.
- Most recent and total connection times are reset to 0 if power is turned off or Internet is disconnected from.
- To reset total transmitted data packets or total connection times, reset values with these procedures or reset to factory default.

Data Communication Area Setting

These settings cannot be changed while Wi-Fi router is connected to Internet.



1 Set each item

Item	Used to	Options	Default
Data communication area setting	Set Area manual selection : Click Apply → Select network operator from list → Apply	Unlimited Data Discount Area/Sub Area auto selection/ Area manual selection	Unlimited Data Discount Area/Sub Area auto selection

2 Click **Apply**

Wi-Fi Settings

1 Click item to set/check

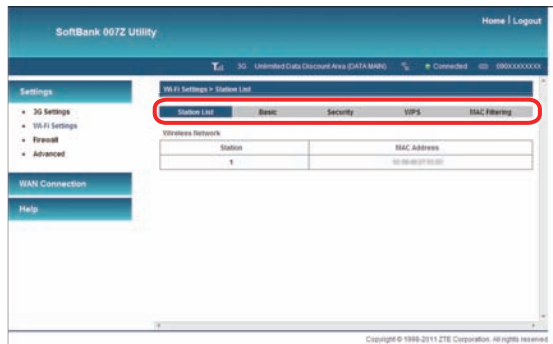

- Station List
- Basic (P.5-9)
- Security (P.5-10)
- WPS (P.5-11)
- MAC Filtering (P.5-12)

Station List

View a list of WLAN MAC addresses connected to Wi-Fi router.

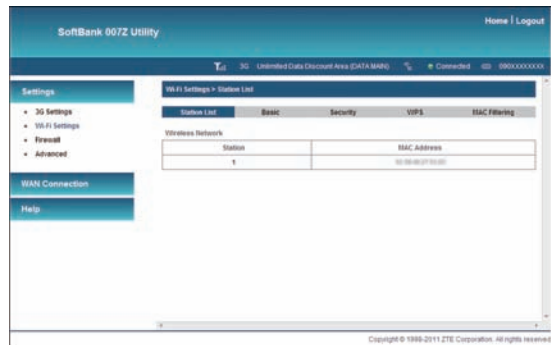

Basic

Set basic settings for wireless network.

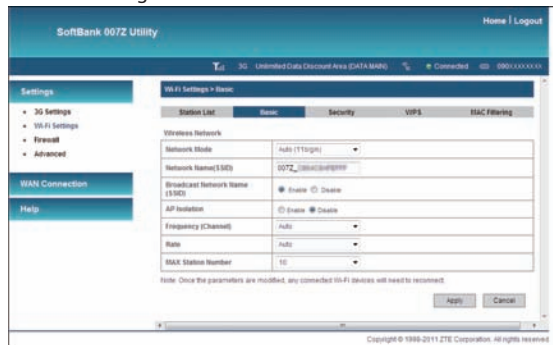

1 Set each item

Item	Used to	Options	Default
Network Mode	Select operation mode for WLAN	Auto (11b/g/n), 11b Only, 11g Only, 11n Only ¹	Auto (11b/g/n)
Network Name (SSID)	Set network name SSID	Available characters: 32 alphanumeric/symbols (except " ' < > & * ¥ , ; : [])	007Z_***** (MAC address) ²
Broadcast Network Name (SSID)	Set whether to show access point	Enable/Disable	Enable

Item	Used to	Options	Default
AP Isolation	Set Wi-Fi device communication option. Setting Disabled prevents file sharing between Wi-Fi devices	Enable/Disable	Disable
Frequency (Channel)	Specify frequency to select	Select from list	Auto
Rate	Specify rate to select	Select from list	Auto
MAX Station Number	Specify the maximum number of Wi-Fi devices to connect	1 to 10	10

¹In these cases, 11n Only is unavailable.

- WEP is set in Security.
- TKIP is set in WPA Algorithms.
- Security mode is set to WPA-PSK and WPA Algorithms is set to Auto.

²See WLAN Initialization Sticker for SSID and WEP key.

- After completing settings, reconnect Wi-Fi devices.
- Wi-Fi communications cannot be used overseas.

2 Click **Apply**

Security

Set security settings for wireless network.



1 Set each item

Item	Used to	Options	Default
Security Mode	Select security mode. The following cannot be set when Network mode is 11n. <ul style="list-style-type: none"> Security mode cannot be set to WPA-PSK. WPA Algorithms cannot be set to Auto. 	OPEN, SHARED, WPA-PSK, WPA2-PSK, WPA-PSK/WPA2-PSK	OPEN

Item	Used to	Options	Default
Encrypt Type	Appears if Security Mode is set to OPEN system. Select Encrypt Type. Cannot be set to WEP when Network mode is 11n.	WEP, NO ENCRYPTION	WEP
Default Key	Appears if Security mode is set to OPEN or SHARED. Set default WEP key	1 to 4	1
WEP Keys	Appears if Security mode is set to OPEN or SHARED. Set WEP key	Hex (64-bit key): 5 alphanumeric/symbols (except , " ; ¥ /), or 10-digit hex number (0-9, A-F) ASCII (128-bit key): 13 alphanumeric/symbols (except , " ; ¥ /), or 26-digit hex number (0-9, A-F)	*
WPA Algorithms	Appears if WPA-PSK, WPA2-PSK, WPA-PSK/WPA2-PSK are selected. Select encryption mode. The following cannot be set when Network mode is 11n. <ul style="list-style-type: none"> TKIP Auto and Security mode cannot be set to WPA-PSK. 	TKIP, AES, Auto	WPA-PSK: TKIP WPA2-PSK: AES WPA-PSK/ WPA2-PSK: Auto

Item	Used to	Options	Default
Pass Phrase	Appears if Security Mode is set to WPA-PSK, WPA2-PSK, WPA-PSK/WPA2-PSK. Set WPA pre-shared key	Available characters: 8-63 alphanumeric/symbols (except , " ; ¥ /), or 64-digit hex number (0-9, A-F)	*

*See "Factory Default Settings" (iv).

2 Click **Apply**

- Previously set Wi-Fi devices may be unavailable with these settings. Change settings.
- For greater security, use WPA/WPA2. Some game consoles may not be WPA compatible.

WPS

Appears if **PIN** is selected. Set PIN for WPS compatible Wi-Fi devices.

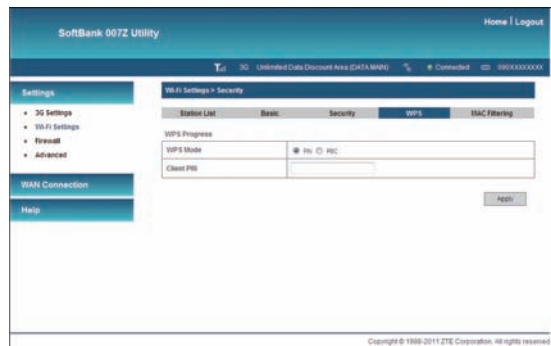

1 Set each item

Item	Used to	Options	Default
WPS Mode	Select WPA communication method	PIN, PBC	PIN
Client PIN	Appears if PIN is selected. Set PIN for WPS compatible Wi-Fi devices	Four digits or eight digits of numerics	-

2 Click **Apply**

- Wi-Fi router WPS function activates automatically. Connect WPS compatible Wi-Fi devices within two minutes.

MAC Filtering

Set up to ten MAC addresses.

SoftBank 007Z Utility

Home | Logout

Settings

- 3G Settings
- Wi-Fi Settings
- Firewall
- Advanced

WAN Connection

Help

Wi-Fi Settings > MAC Filtering

Station List

MAC Filtering

The MAC address in the following list would be:

MAC Address

00:1E:90:FF:FF:FF

Deny

Apply

MAC Address List

No.	MAC Address	Action
1	00:1E:90:FF:FF:FF	Deny

Note: Once the MAC address list is empty, all the MAC address would be accepted.

Apply

Copyright © 1999-2011 ZTE Corporation. All rights reserved.

1 Set each item

Item	Used to	Options	Default
The MAC address in the following list would be:	Select Denied or Accepted.	Denied, Accepted	Denied
MAC Address	Set up to ten MAC address to accept/deny.	Six sets of numbers (00 to FF)	-

Firewall & Port Filtering Settings

1 Click item to set/check

SoftBank 007Z Utility

Home | Logout

Settings

- 3G Settings
- Wi-Fi Settings
- Firewall
- Advanced

WAN Connection

Help

Firewall & Port Filtering

IP/Port Filtering

Port Mapping

Basic Settings

IP/Port Filtering

Default Policy - The packet that doesn't match with any rules would be:

Accepted

Apply

IP/Port Filtering Settings

Dest. IP Address

Src. IP Address

Protocol

Dest. Port Range

Src. Port Range

Action

Comment

The maximum rule count is 10.

Apply

Reset

Current IP/Port Filtering Rules in System:

No.	Dest. IP Address	Src. IP Address	Protocol	Dest. Port Range	Src. Port Range	Action	Comment
Others would be accepted							

Deny

Reset

Copyright © 1999-2011 ZTE Corporation. All rights reserved.

■ IP/Port Filtering (P.5-13)

■ Port Mapping (P.5-14)

IP/Port Filtering

Set/apply rules whether to connect or not if setting IP addresses and port numbers.

The screenshot shows the 'IP/Port Filtering' settings in the SoftBank 007Z Utility. The 'Basic Settings' section includes a checkbox for 'IP/Port Filtering' (checked), a 'Default Policy' dropdown set to 'Accepted', and a 'Port Mapping' button. The 'IP/Port Filtering Settings' section includes fields for 'Dest. IP Address' (193.100.100.100), 'Src. IP Address' (193.100.100.100), 'Protocol' (TCP), 'Dest. Port Range' (1-65535), 'Src. Port Range' (1-65535), and 'Action' (Drop). Below this is a 'Current IP/Port Filtering Rules in System' table with columns: No., Dest. IP Address, Src. IP Address, Protocol, Dest. Port Range, Src. Port Range, Action, and Comment. The table is currently empty.

1 Set each item

Item	Used to	Options	Default
IP/Port Filtering	Select action mode for IP/Port Filtering	Enable, Disable	Disable

Item	Used to	Options	Default
Default Policy – The packet that doesn't match with any rules would be:	Set action for IP/Port Filtering	Accepted, Dropped	Accepted
Dest. IP Address	Set destination IP address to apply rules	Four sets of numbers (0 to 255)	-
Src. IP Address	Set source IP address to apply rules	Four sets of numbers (0 to 255)	-
Protocol	Select protocols that apply rules	TCP, UDP, ICMP	TCP
Dest. Port Range	Set destination port number or range to apply rules	1 to 65535 Link with "-" when specifying range	-
Src. Port Range	Set source port number or range to apply rules	1 to 65535 Link with "-" when specifying range	-
Action	Select action to set rules	Drop, Accept	Drop
Comment	Enter comments regarding rules	Alphanumerics	-

2 Click **Apply**

- Filtering rules appear in Current IP/Port Filtering Rules in System list.
To delete rule, check Box and click **Delete**.
To clear Boxes of all checks, click **Reset**.

Port Mapping

Set rules so that specific device port access in the LAN can be controlled from Internet. Set a maximum of ten forwarding rules.

Item	Used to	Options	Default
Dest. Port Range	Set destination port number	1 to 65535	-
Protocol	Set protocol to use	TCP+UDP, TCP, UDP	TCP+UDP
Comment	Enter comments regarding rules	Alphanumerics	-

2 Click **Apply**

Applied Port Mapping rules appear on Current Port Mapping Rules in System list.

- To delete rule, check Box and click **Delete**.
- To clear Boxes of all checks, click **Reset**.

1 Set each item

Item	Used to	Options	Default
Port Mapping	Select Port Forwarding action mode	Enable, Disable	Disable
Src. Port	Set port numbers to open up	1 to 65535	-
Src. IP Address	Set IP address to open port	Four sets of numbers (0 to 255)	-

Advanced

1 Click item to set/check

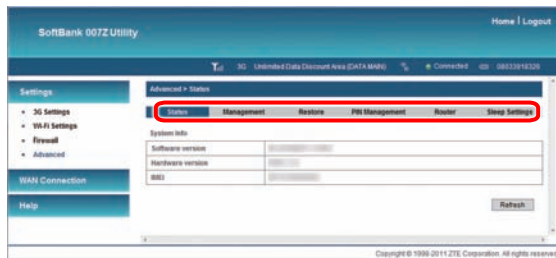

- Status (P.5-15)
- Management (P.5-16)
- Restore (P.5-16)
- PIN Management (P.5-17)
- Router (P.5-18)
- Sleep Settings (P.5-19)

Status

View hardware information.

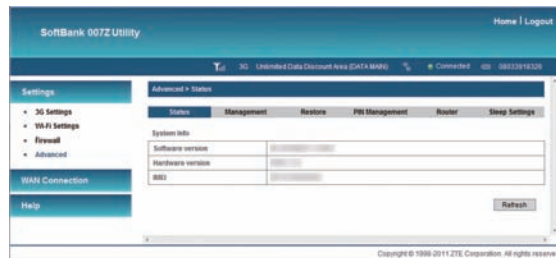

Management

Change SoftBank 007Z Utility default Administrator Password ("admin").

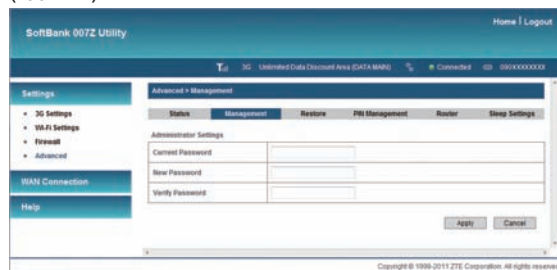

- 1 Enter current Password, new Password, then enter new Password again for verification

Item	Used to	Options	Default
Password	-	Available characters: alphanumerics/ symbols (except " ' < > & * ¥ , ; : [])	admin

- 2 Click **Apply**

Restore

Reset all Wi-Fi router settings to their factory defaults.

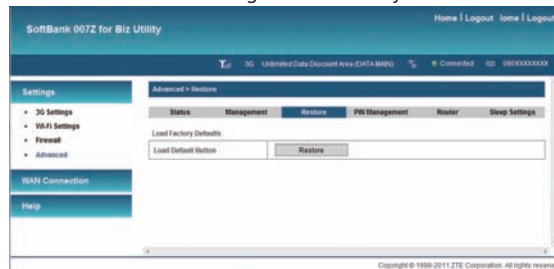

- 1 Click **Restore**
 - 2 Click **OK** to reset to factory defaults
- Defaults are restored. Wi-Fi router automatically restarts and Login window opens. Log in to continue.

PIN Management

Personal Identification Number (PIN) is USIM security code. Change PIN, or Enable/Disable PIN Authentication to control USIM access.



To Enable/Disable PIN Authentication

Enable PIN Authentication, power on Wi-Fi router, then use SoftBank 007Z Utility to enter PIN.

1 Select **Enable/Disable** from Action

2 Enter PIN correctly in PIN

Item	Used to	Options	Default
Action	Select operation to apply	Enable, Disable, Modify	Disable
PIN	Current PIN	Four to eight-digit number	9999

3 Click **Apply**

Changing PIN

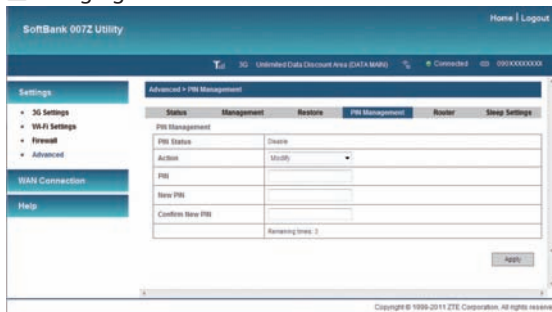

1 Select **Modify** → **Enable**

2 Set each item

Item	Used to	Options	Default
PIN	Enter current PIN	Four to eight-digit number	9999
New PIN	Enter new PIN	Four to eight-digit number	-
Confirm New PIN	Enter new PIN again for confirmation	Four to eight-digit number	-
PUK	Appears when PIN Lock is enabled. Enter PUK Code	Eight-digit number	-

3 Click **Apply**

- SoftBank 007Z Utility required to change PIN. Disable PIN operations for Wi-Fi devices other than computers.
- Log into SoftBank 007Z Utility to enable PIN Authentication. PIN Authentication window appears: Enter PIN → Click **Apply**
- Incorrectly entering PIN three consecutive times activates PIN Lock. PUK Code is required to unlock it. For details about PUK, contact SoftBank Customer Support, General Information (P.7-3). Entering PUK Code ten consecutive times locks Wi-Fi router completely. If Wi-Fi router is completely locked, predefined procedures are required. Contact SoftBank Customer Support, General Information (P.7-3).

Router

These settings cannot be changed while Wi-Fi router is connected to Internet.

SoftBank 007Z Utility

Home | Logout

Tel 3G Unlimited Data Discount Area (DATA MAP) Control 00 0000000000

Settings

- 3G Settings
- Wi-Fi Settings
- Firewall
- Advanced

WAN Connection

Help

Advanced > Router

Status Management Restore PIN Management Router Sleep Settings

LAN Interface Setup

IP Address

Subnet Mask 255.255.255.0

MAC Address

DHCP Server Enable

DHCP IP Pool

DHCP Lease Time 24 hours

Note: Your settings will be effective after rebooting your device.

Apply Cancel

Copyright © 1998-2011 ZTE Corporation. All rights reserved.

1 Set each item

Item	Used to	Options	Default
IP Address	Set private IP address	Four sets of numbers (0 to 255)	192.168.3.1
Subnet Mask	Set subnet mask	Four sets of numbers (0 to 255)	255.255.255.0
MAC Address	Confirm Wi-Fi router MAC address	Six sets of numbers (00 to FF)	-
DHCP Server	Select DHCP server action mode	Enable/Disable	Enable

Item	Used to	Options	Default
DHCP IP Pool	Set DHCP IP pool starting address and ending address	Four sets of numbers (0 to 255) • Starting address value must be smaller than ending address • Do not include IP address in pool • Starting IP address and ending IP address must be in LAN subnet pool	192.168.3.2 to 192.168.3.253
DHCP Lease Time	Set IP address lease time	1 to 65535	24

2 Click **Apply**

A confirmation appears.

Sleep Settings

If ON, idle Wi-Fi router (no transmissions/battery charged) goes to sleep. Activate/cancel sleep mode; set sleep activation timer.

1 Set each item

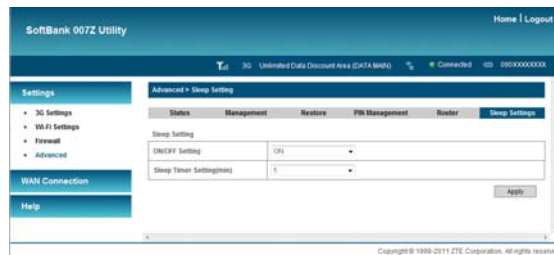

Item	Used to	Options	Default
ON/OFF Setting	Activate/cancel sleep mode	ON/OFF	ON
Sleep Timer Setting(min)	Set sleep mode activation timer	1/3/5/10/15	1

1 Click **Apply**

Changing Security

Change security from default WEP.

1 Click **Settings**

2 In Connection menu, select **Wi-Fi Settings**

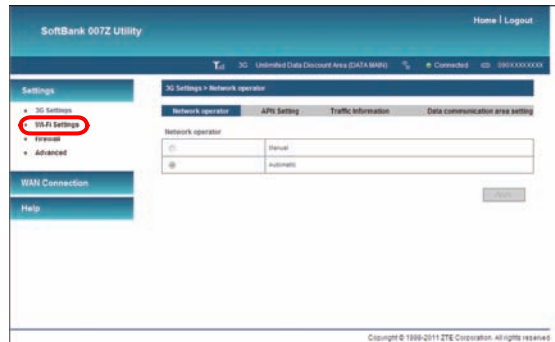

3 Click **Security**

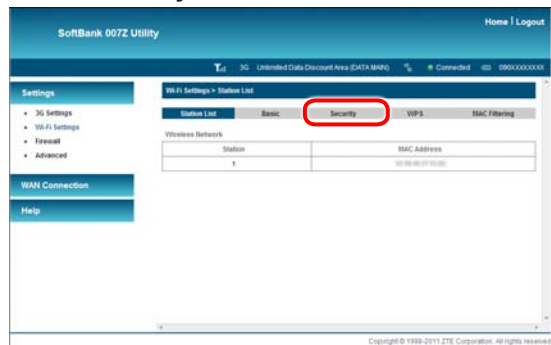

- 4 Open Security Mode menu to select security
- Select WPA-PSK, WPA2-PSK or WPA-PSK/WPA2-PSK.

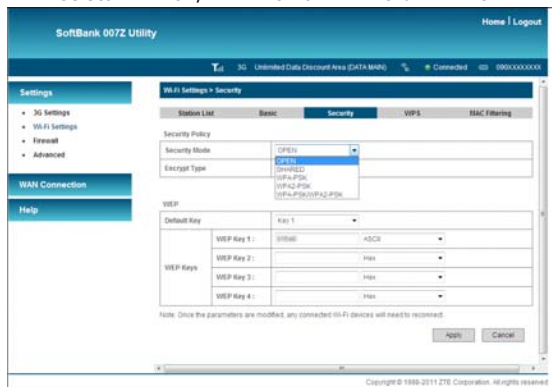

- 5 Set items as required
- See "Security" (5-10).
- 6 Click **Apply**

Internet Connectivity

Connection

Manage Internet connectivity manually via SoftBank 007Z Utility.

- 1 Click **WAN Connection**
- 2 In Connection menu, select Always On → **Apply**
- Alternatively, open Manual menu → Select **Connect Internet** → **Apply** for manual Internet connection.

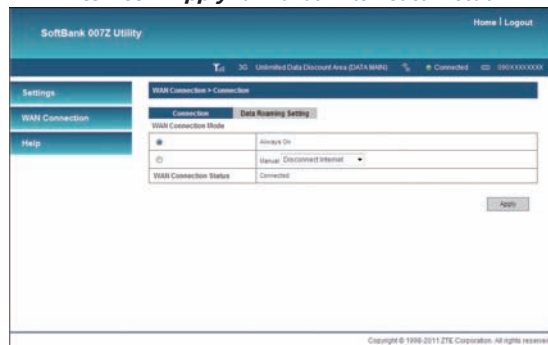

- 3 To end Wi-Fi router Internet connection, open Manual menu → Select **Disconnect Internet** → **Apply**

Data Roaming Setting

1 Click **WAN Connection** → **Data Roaming Setting**

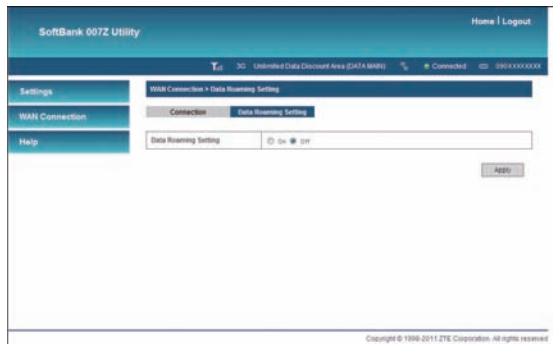

2 In Data Roaming Setting field, select **On** or **Off**

- Click **Apply**
- Even if Data Roaming Setting is set to Off, press and hold CONNECT Key to activate Internet connectivity.

Troubleshooting	6-2
-----------------------	-----

Case	Refer
1. Unable to connect WLAN	P.6-2
2. PC does not recognize Wi-Fi router	P.6-3
3. Installer does not automatically activate	P.6-4
4. Internet connection fails	P.6-4
5. Transmission fails	P.6-4
6. Transmissions are slow	P.6-4
7. Forgot PIN/Unknown PUK Code/USIM Card is locked	P.6-4
8. USIM Card is not recognized	P.6-4
9. Confirming Administrator logon	P.6-5
10. "NO SERVICE" appears outside Japan	P.6-5
11. Resetting factory defaults (Reset)	P.6-5
12. Old phone number appears in utility software	P.6-5
13. Connection failed without notice	P.6-5

1. Unable to connect WLAN

- 1 Make sure Wi-Fi router is properly connected to PC
- 2 If WPS connection fails, see Wi-Fi modem user guide or set Wi-Fi router manually (See "Connecting Wi-Fi Devices via WLAN" (P.2-2))
- 3 To connect to WPS PIN specified WLAN, confirm PIN (See "WPS" (P.5-11))
- 4 Confirm WEP Key (If forgotten, reset defaults (See "11. Resetting factory defaults (Reset)" (P.6-5)) or set WEP Key (See "Security" (P.5-10)) → Reconnect WLAN
- 5 To connect to WPS PIN specified WLAN, confirm PIN (See "Security" (P.5-10)) → Reconnect WLAN
Some Wi-Fi devices do not support WPA/WPA2. See WLAN user guide

2. PC does not recognize Wi-Fi router

1 Confirm that Wi-Fi router is properly installed

2 Remove Wi-Fi router from PC, restart PC, then reconnect Wi-Fi router

- For Windows 7 or Windows Vista, follow these steps to confirm proper Wi-Fi router installation.

- 1 Right click **Computer** → **Properties** → **System Settings** → **User Account Control** → **Yes** (Windows 7) or **Continue** (Windows Vista)
- 2 In System Properties, select **Hardware** tab, then click **Device Manager**

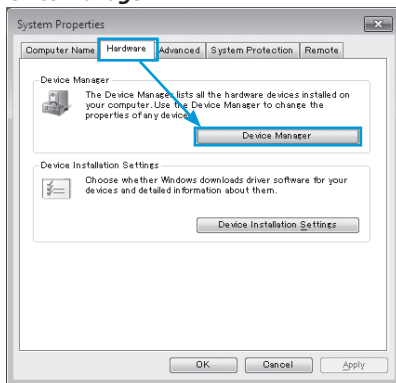

- Windows XP: Right click **My Computer** → **Properties**
In System Properties, select **Hardware** tab → **Device Manager**

- 3 Confirm that devices outlined below appear (COM port numbers vary by PC operating environment)

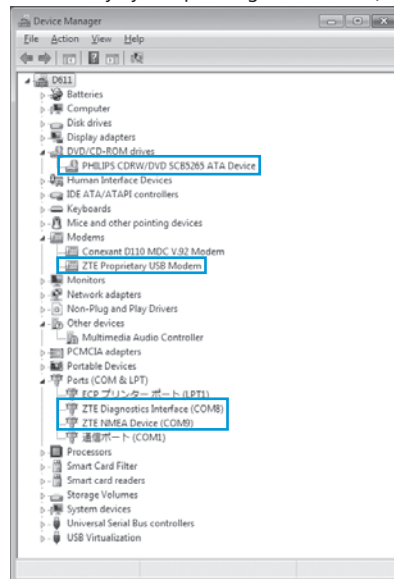

3. Installer does not automatically activate

New hardware recognition takes a few seconds. If installer does not automatically activate, remove Wi-Fi router from PC, then restart PC. If installer does not activate automatically, see P.3-5, P.3-6.

4. Internet connection fails

Make sure you are within the service area.

- If signal reception is poor, move to where signal is strong, then reconnect.
- The access point might be busy depending on the time of day, wait a little while then reconnect.
- Activate SoftBank 007Z Utility and confirm that 3G settings and network settings are correct. See "Advanced Settings" (P.5-4).

5. Transmission fails

- 1** Make sure Wi-Fi router is properly connected to PC
- 2** Signal may be weak. Move to where signal is stronger
- 3** Remove Wi-Fi router from PC and then reconnect it
- 4** If Steps **1** to **3** do not re-establish a connection, remove Wi-Fi router, restart PC, and try again

6. Transmissions are slow

Signal may be weak. Move to where signal is stronger. Connection may be poor. Try again later.

7. Forgot PIN/Unknown PUK Code/USIM Card is locked

Contact SoftBank Customer Support, General Information (P.7-3).

8. USIM Card is not recognized

- 1** Confirm that USIM Card is properly installed
See "USIM Card Installation" (P.1-5)
- 2** Check USIM Card for damage
- 3** Check USIM Card IC chip for scuffs/corrosion
- 4** Debris on USIM Card IC chip may prevent recognition.
Clean it with a soft cloth
- 5** Contact SoftBank Customer Support, General Information (P.7-3)

9. Confirming Administrator logon

- For Windows 7 or Windows Vista
 - 1 Click **Start menu** → **Control Panel**
 - 2 Click **User Accounts and Family Safety** → **User Accounts**
 - 3 User name and account type appear on the right. If "Administrator" appears, set up Wi-Fi router
- For Windows XP
 - 1 Click **Start**
 - 2 Current user name appears at top of Start menu
 - User name does not appear in Classic Start menu: Right click **Start menu** → **Properties** → Start menu radio button.
 - 3 Click **Start** → **Control Panel**
 - 4 Click **User Accounts**
 - 5 Check user name in Step 2. If "Administrator" appears below user name, set up Wi-Fi router

10. "NO SERVICE" appears outside Japan

Power off and restart.

11. Resetting factory defaults (Reset)

- Using RESET Key
 - 1 Remove Cover → Press RESET Key
- Using WPS Key & Power Key
 - 1 Long Press WPS Key and Power Key simultaneously.
- Reset via SoftBank 007Z Utility
 - 1 In SoftBank 007Z Utility, **Settings** → **Advanced** → **Restore**
 - 2 Click **Restore**

12. Old phone number appears in SoftBank 007Z Utility

Depending on contract/cancellation method, old phone number may appear in SoftBank 007Z Utility.

13. Connection failed without notice

Connection method may change. Confirm connection method on Display.

- Manual Connection

Press and hold CONNECT Key to toggle auto/manual. Set to auto connection. If using utility, changing via PC is available. See "Internet Connectivity" (P.5-21).
- Auto Connection

Power off and reconnect.

Appendix	7-2
Specifications.....	7-2
Warranty & Service.....	7-2
Customer Service	7-3

Specifications

Model Name	SoftBank 007Z
Dimensions	102 mm (D) × 53 mm (W) × 16.6 mm (H)
Weight*	97 g
Interface	USB 2.0
	microSD Card or microSDHC Card
Power Consumption*	3.0 W Power consumption varies by usage.
Operating Environment	Operating Temperature: -10 to +45°C Operating Humidity: 5% to 95%
Frequency	W-CDMA: 1500 MHz, 1700 MHz
Compatible Networks	WAN: 3G (W-CDMA); 3G High Speed (HSPA+/HSDPA, HSPA+, DC-HSDPA) WLAN: IEEE802.11b/g/n

*Approximate value

Warranty & Service

Wi-Fi router purchase includes Warranty.

- Confirm shop name and purchase date.
- Read contents of Warranty and keep it in a safe place.
- The warranty period can be found in the Warranty.
- Before submitting Wi-Fi router for repairs, contact SoftBank Customer Support, General Information (P.7-3) or SoftBank Shop; be prepared to describe problem in detail.
- During the warranty period, repairs will be made under the terms and conditions described in the warranty.
- After the warranty period, repairs will be upon request; if said repairs can be made, you will be charged for them.

- SoftBank Mobile is not liable for any damages resulting from the use of this Wi-Fi router.
- Files and settings may be lost or altered due to accidents or repairs. Keep a copy of important files, etc. SoftBank Mobile is not liable for damages resulting from accidental loss or alteration of files or settings.
- Disassembling or modifying this Wi-Fi router may be a violation of the Radio Law. Note that SoftBank Mobile does not accept repair requests for disassembled or modified products.
- For more information, contact SoftBank Shop or SoftBank Customer Support, General Information (P.7-3).

Customer Service

For information about SoftBank Mobile devices or services, call General Information.
For repairs, call Customer Assistance.

SoftBank Customer Support

General Information

- From a SoftBank handset, dial toll free at 157
- From a landline/IP phone, dial toll free at 0800-919-0157

Customer Assistance

- From a SoftBank handset, dial toll free at 113
- From a landline/IP phone, dial toll free at 0800-919-0113

If you cannot reach a toll free number, use the number (charges apply) below for your service area:

Hokkaido Area Tohoku Area Hokuriku Area Kanto, Koshinetsu Area	022-380-4380	Tokai Area	052-388-2002
Kansai Area	06-7669-0180	Chugoku, Shikoku Area Kyushu, Okinawa Area	092-687-0010

SoftBank Technical Support Center (Setup, Operations & Technical Issues)*

Service Hours 9:00-20:00

From a SoftBank handset, dial toll free at 5525

From a landline/IP phone, dial toll free at 0088-21-5525

*These numbers cannot be dialed from outside Japan.

SoftBank Mobile Global Call Center

From outside Japan, dial +81-3-5351-3491 (toll free from SoftBank handsets)

If 007Z is lost/stolen, call this number immediately (international charges apply)

ZTE Japan Customer Support Website (Japanese)

http://www.zte.co.jp/products/handsets/handsets_gallery/

SoftBank 007Z User Guide

December 2011, Third Edition

SOFTBANK MOBILE Corp.



モバイル・リサイクル・ネットワーク
携帯電話・PHSのリサイクルにご協力を。

Please help the mobile industry maintain high environmental standards. Recycle your old handsets, batteries and charger units (all manufacturers and brands). Before you recycle, please remember these important points:

- Handsets, batteries and chargers submitted for recycling cannot be returned.
- Always erase all data on old handsets (Phone Book entries, call records, mail, etc.).

Model Name: SoftBank 007Z

Manufacturer: ZTE Corporation
